

Kanturk

To Kanturk Town Centre

- NOTE:
1. THIS DRAWING IS COPYRIGHT.
 2. THIS DRAWING MUST NOT BE SCALED.
 3. THE CONTRACTOR IS TO CHECK ALL DIMENSIONS ON SITE.
 4. FOR ANY DISCREPANCIES FOUND, CONSULT WITH DESIGN OFFICE.
 5. THE DRAWING IS TO BE READ IN CONJUNCTION WITH ALL SPECIFICATION DOCUMENTS.



Cork County Council Owned Lands

Planning Application Site Boundary delineated in Red
Area of Site 403sq.m / 0.099 Acres

ORDNANCE SURVEY IRELAND SHEET NUMBERS:
5885-A
5814-C

ITM for corner of the site
537,271
602,989

- Legend**
- GY Surveyed Gully Trap
 - LP Surveyed Lamp Post
 - MH Surveyed Manhole
 - CL Surveyed Cover level
 - IL Surveyed Invert level
 - STC Surveyed Stop Cock
 - WL Surveyed Wall level
 - Proposed 1.8m high concrete post & panel fence
 - Existing railing mounted on low stone wall
 - Existing public footpath
 - Extent of footpath to be disturbed
 - Existing estate road
 - Existing green area
 - Proposed private open space

P03	Re Issued for Planning	27.04.22
P02	Issued for Planning	08.04.22
P01	Issued for MD Meeting	28.03.22
Rev. No.	Revision Description	Date

Project Stage: Single Stage Submission

Project Title: Proposed Dwelling
22 Aisling Gheal, Kanturk.

Drawing Title: Proposed Site Layout Plan

Comhairle Contae Chorcaí
Ailtirí | Stúdíó Treacht Títhíochta

Cork County Council
Architects | Housing Directorate

County Hall, Cork
Tel: (021) 4285433
e-mail: architects.housing@corkcoco.ie

Job Reference: N2007110	Design Team: Architect: JC Technician: TOF Surveyor: RB Snr. Architect: R. Henry
Dwg. No.: DR-CCC-A-PL-120	Sheet: A3
Date: 28.03.22	Scale: 1:250
Issue for: Planning	Issue for: Planning

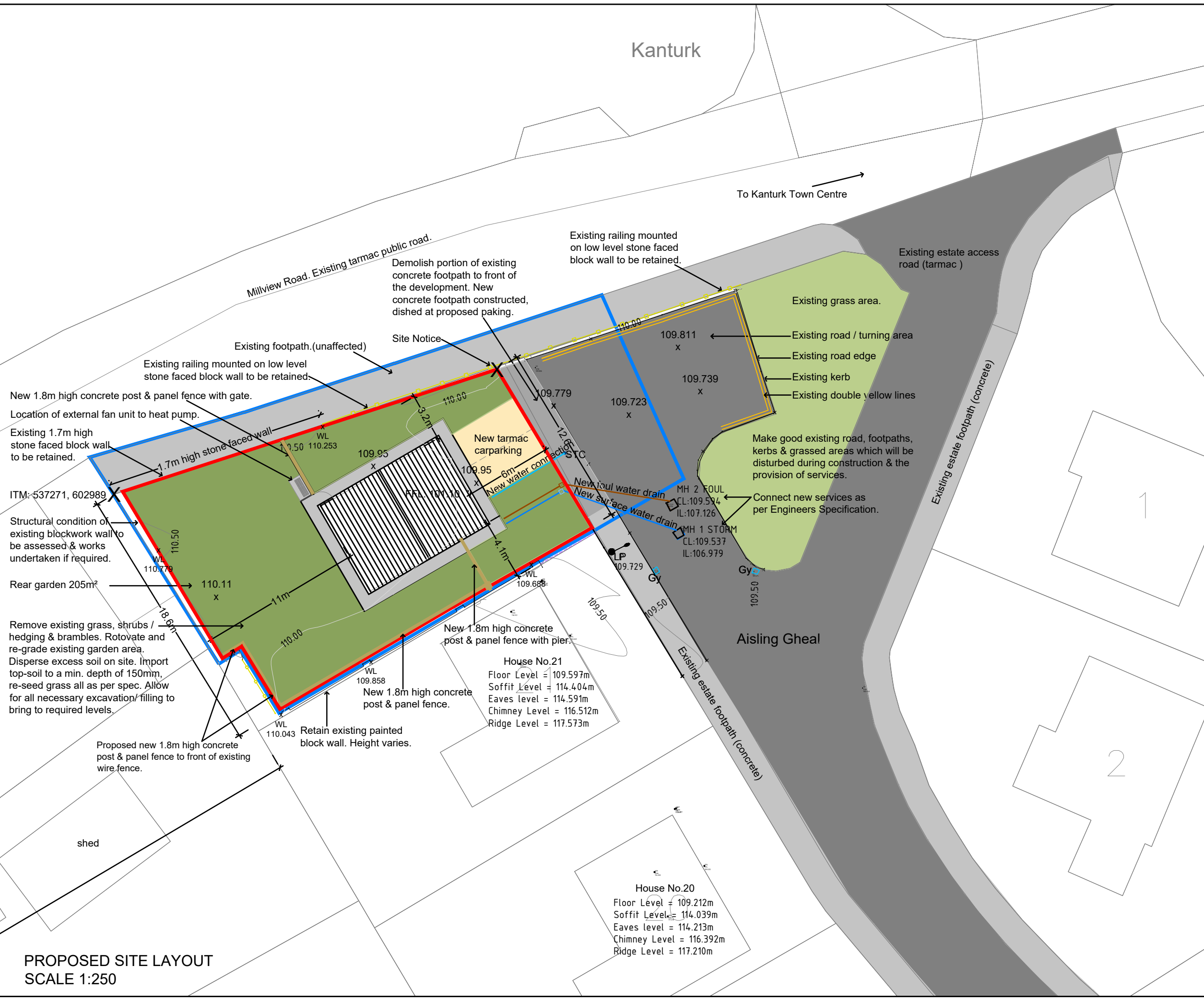

PROPOSED SITE LAYOUT
SCALE 1:250