

NOTES:
 All dimensions in metres.
 Do not scale from drawing.
 For any discrepancies found please consult with design office.
 This drawing should be read in conjunction with all contract drawings, documents and specifications.

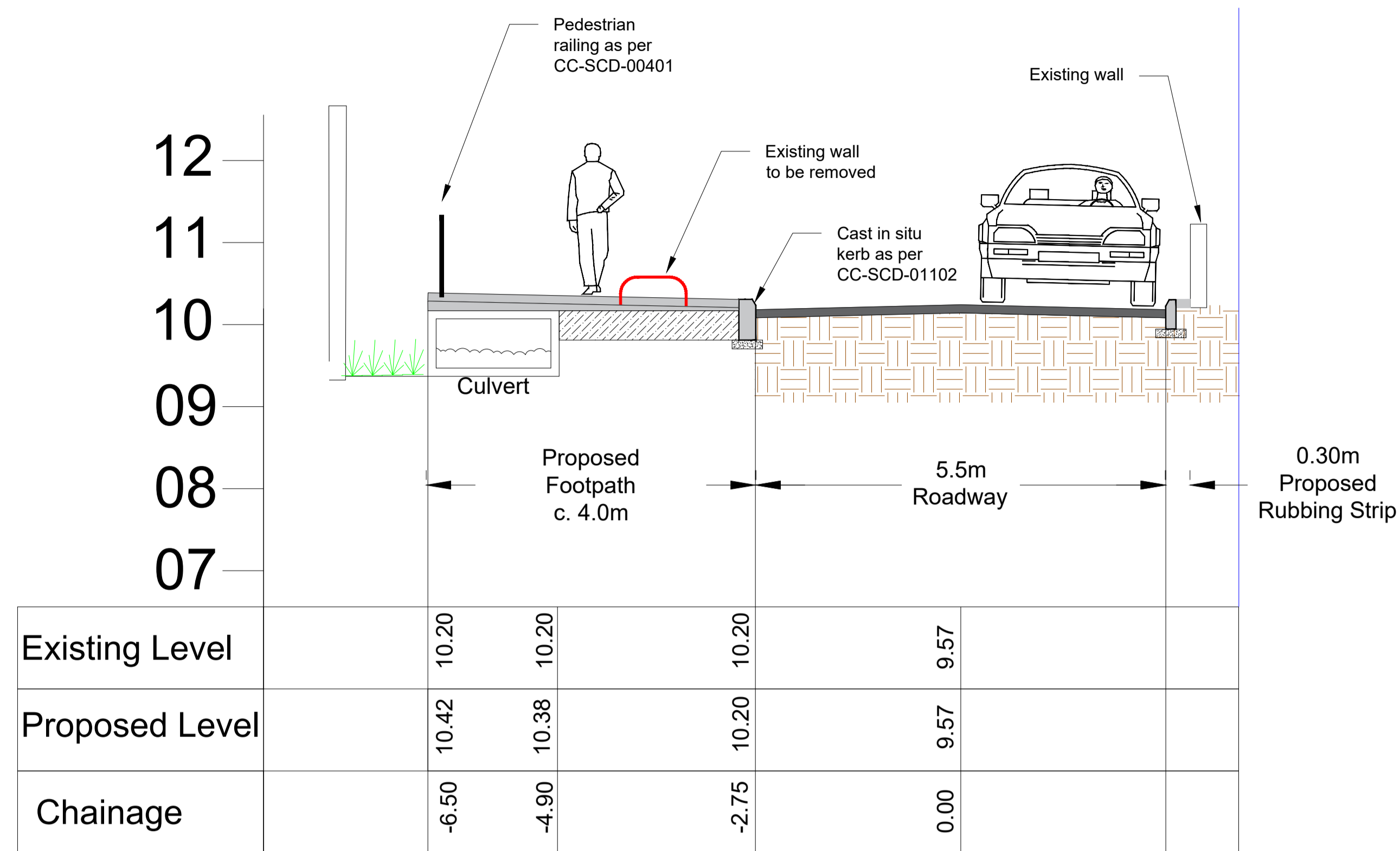

Section E-E

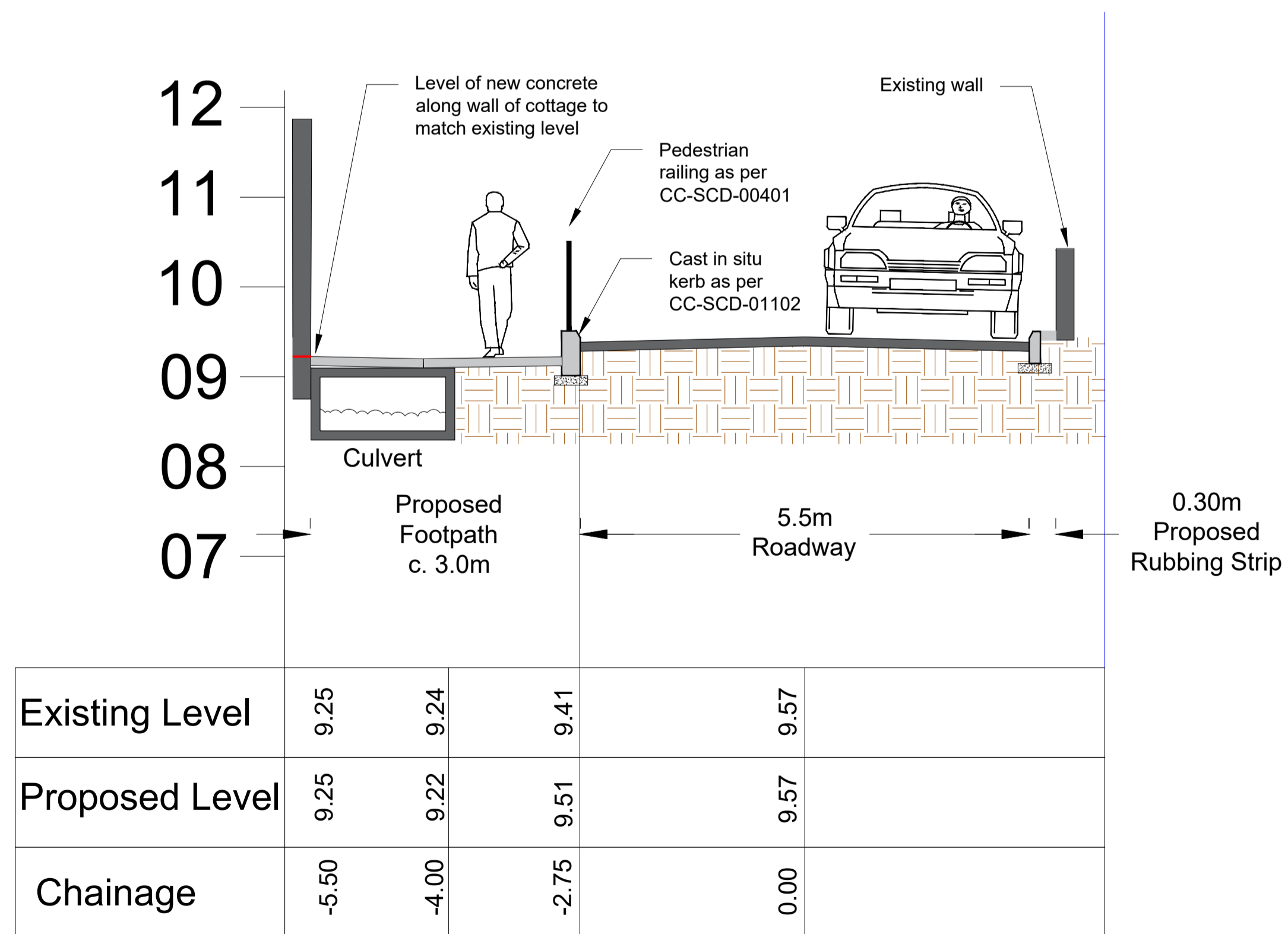

Section F-F

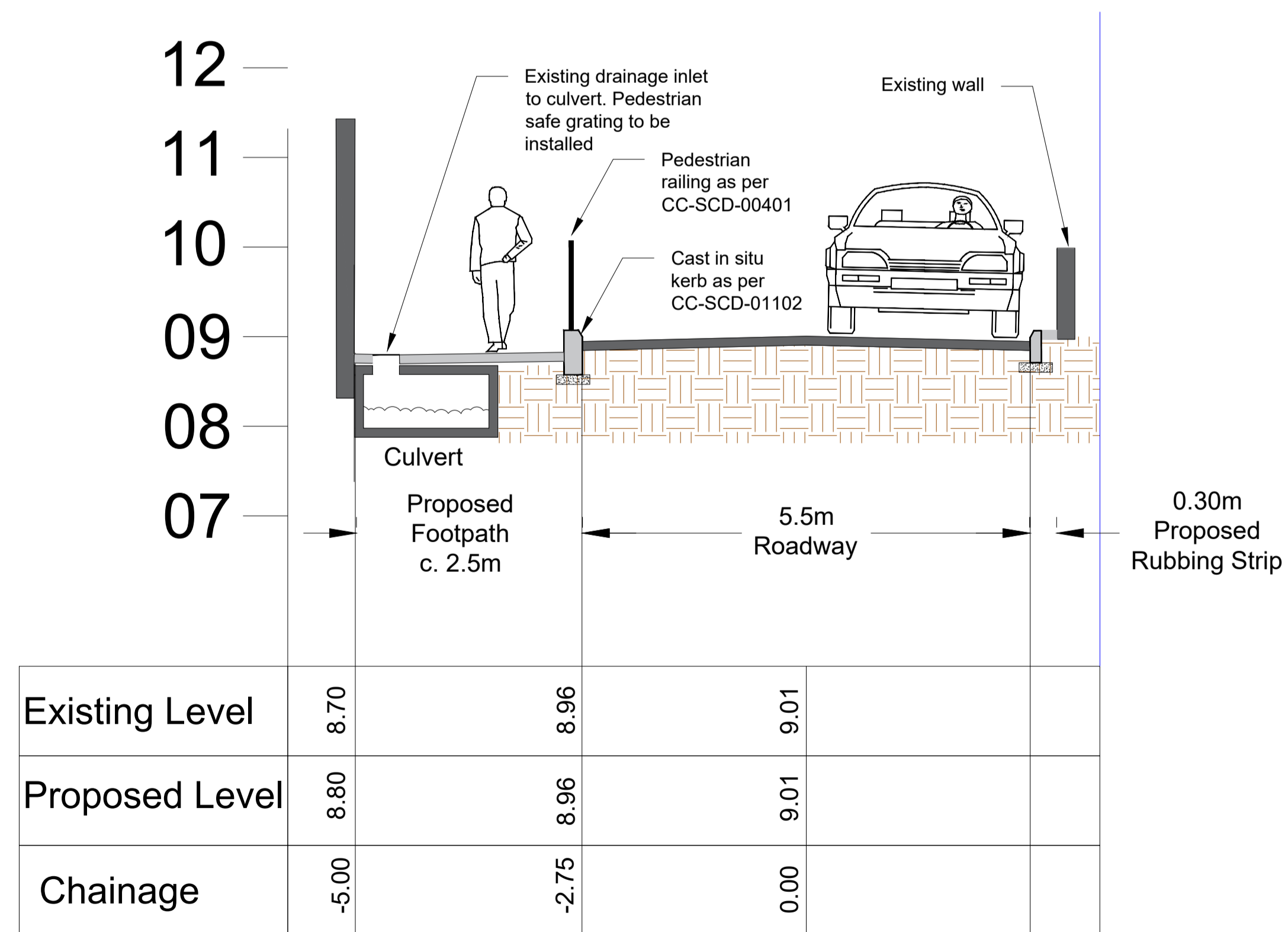

Section G-G

Rev	By	Date	Description
-----	----	------	-------------

01	FOS	27/04/22	Road width changed to 5.5m
----	-----	----------	----------------------------

Drawing Status: DISCUSSION
NOT CERTIFIED FOR CONSTRUCTION

Project Title: Church Bay Road, Crosshaven, Cork

Drawing Title: Culvert Cross Sections

Client: Cork County Council

M.H.L. & Associates Ltd.
 Consulting Engineers
 Carriga Mór House,
 10 High Street,
 Douglas Road,
 Cork
 Tel: 021-4840214
 Fax: 021-4840215
 E-Mail: info@mhl.ie

Designed: FOS **Drawn:** FOS **Checked:** KM

Scale: 1/100 @A3 **Date:** April 2021

Job No: 21048RD **Drawing No:** 21048RD-CXS-D01 **Revision:**



Proposed zebra crossing with associated public lighting.
Setup to mirror existing zebra crossing on Camden Road.

Existing ESB pole to be retained

Existing inlet to culvert.
Cover to be lowered/raised as required.

Existing inlet to culvert.
Cover to be lowered/raised as required.

NOTES:
All dimensions in metres.
Do not scale from drawing.
For any discrepancies found please consult with design office.
This drawing should be read in conjunction with all contract drawings, documents and specifications.

- LEGEND:**
- Existing carriageway
 - Existing footpath
 - Proposed footpath/buildout. 2m minimum width unless stated otherwise.
 - Existing gully
 - Existing gully to be removed
 - Proposed gully
 - Existing ESB poles
 - Existing trees to be removed
 - Existing wall to be removed
 - Proposed 25mm dropped kerbs at vehicular entrances
 - 300mm concrete rubbing strip where required
 - Proposed pedestrian railing as per CC-SCD-00401

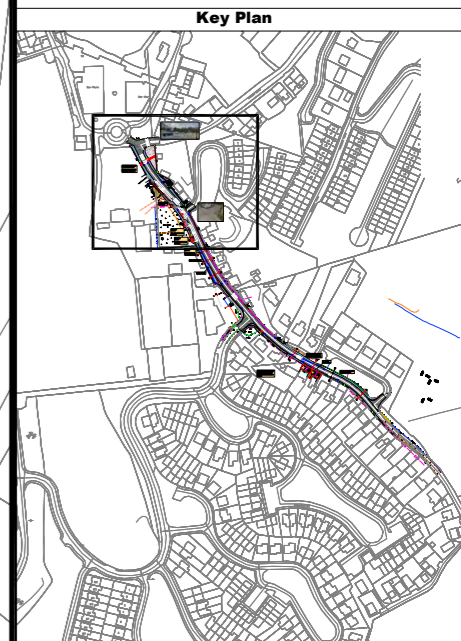

Rev	By	Date	Description
01	FOS	01/03/22	Parallel parking included on Church Bay Rd

Drawing Status: DISCUSSION
NOT CERTIFIED FOR CONSTRUCTION

Project Title: Church Bay Road, Crosshaven, Cork

Drawing Title: Option 2
General Layout (1 of 3)

Client: Cork County Council

M.H.L. & Associates Ltd.
Consulting Engineers

Carrig Mór House,
10 High Street,
Douglas Road,
Cork

Tel: 021-4840214
Fax: 021-4840215
E-Mail: info@mhl.ie

Designed: FOS	Drawn: FOS	Checked: KM
Scale: 1/500 @A3	Date: March 2021	
Job No: 21048RD	Drawing No: 21048RD-2GL-D01	Revision: 01

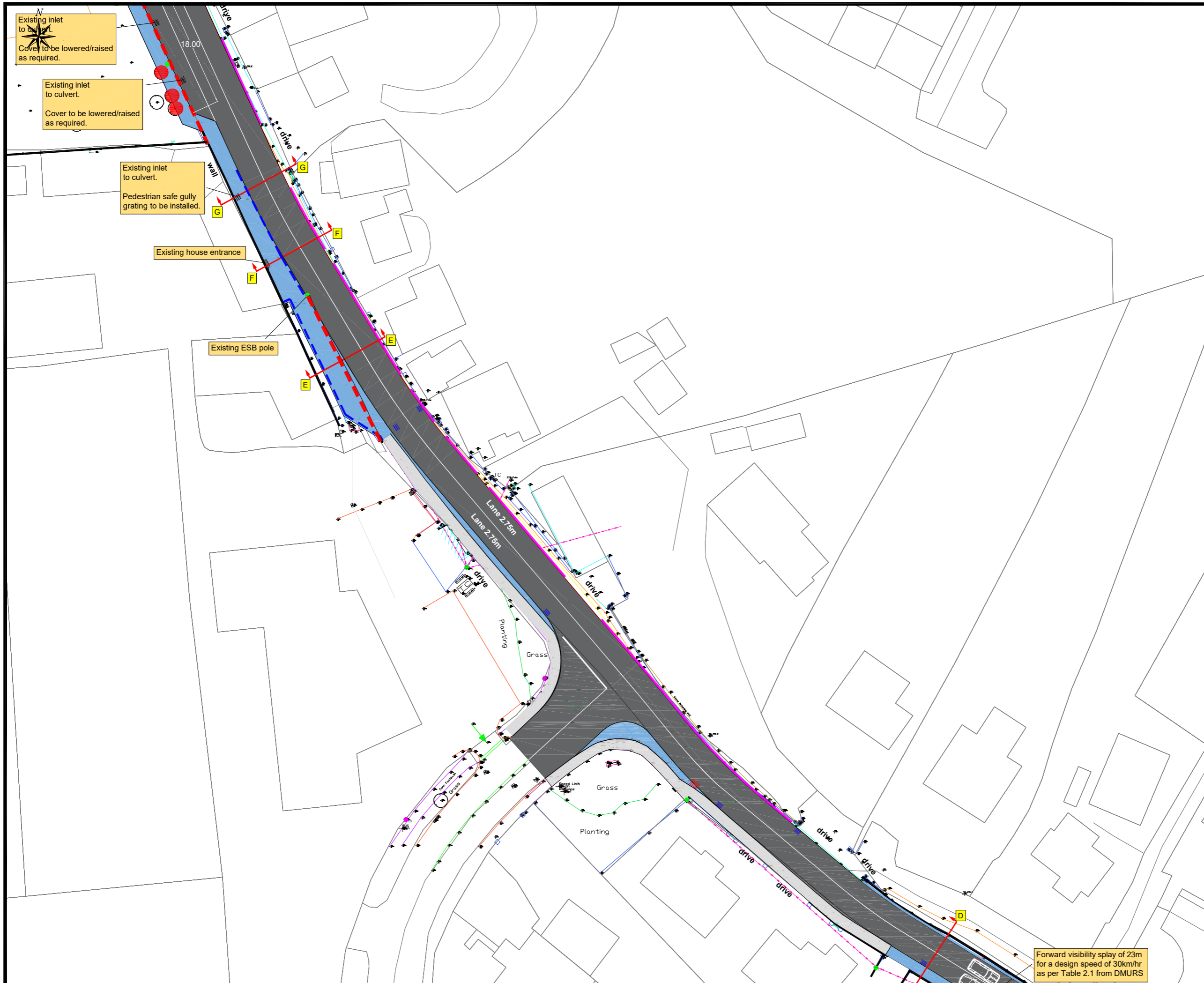

NOTES:
 All dimensions in metres.
 Do not scale from drawing.
 For any discrepancies found please consult with design office.
 This drawing should be read in conjunction with all contract drawings, documents and specifications.

- LEGEND:**
- Existing carriageway
 - Existing footpath
 - Proposed footpath/buildout. 2m minimum width unless stated otherwise.
 - Existing gully
 - Existing gully to be removed
 - Proposed gully
 - Existing ESB poles
 - Existing trees to be removed
 - Existing wall to be removed
 - Proposed 25mm dropped kerbs at vehicular entrances
 - 300mm concrete rubbing strip where required
 - Proposed pedestrian railing as per CC-SCD-00401

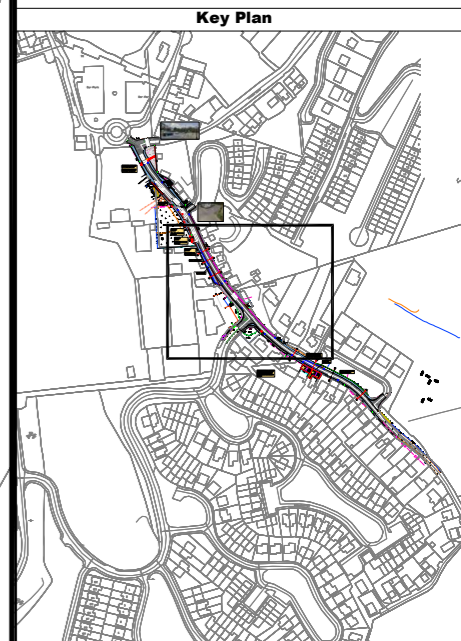

Rev	By	Date	Description
01	FOS	01/03/22	Parallel parking included on Church Bay Rd

Drawing Status: DISCUSSION
NOT CERTIFIED FOR CONSTRUCTION

Project Title: Church Bay Road, Crosshaven, Cork

Drawing Title: Option 2
 General Layout (2 of 3)

Client: Cork County Council

M.H.L. & Associates Ltd.
Consulting Engineers

Carrig Mór House,
 10 High Street,
 Douglas Road,
 Cork

Tel: 021-4840214
 Fax: 021-4840215
 E-Mail: info@mhl.ie

Designed: FOS	Drawn: FOS	Checked: KM
Scale: 1/500 @A3	Date: March 2021	
Job No: 21048RD	Drawing No: 21048RD-2GL-D02	Revision: 01

Forward visibility splay of 23m
 for a design speed of 30km/hr
 as per Table 2.1 from DMURS



NOTES:
 All dimensions in metres.
 Do not scale from drawing.
 For any discrepancies found please consult with design office.
 This drawing should be read in conjunction with all contract drawings, documents and specifications.

- LEGEND:**
- Existing carriageway
 - Existing footpath
 - Proposed footpath/buildout. 2m minimum width unless stated otherwise.
 - Existing gully
 - Existing gully to be removed
 - Proposed gully
 - Existing ESB poles
 - Existing trees to be removed
 - Existing wall to be removed
 - Proposed 25mm dropped kerbs at vehicular entrances
 - 300mm concrete rubbing strip where required
 - Proposed pedestrian railing as per CC-SCD-00401

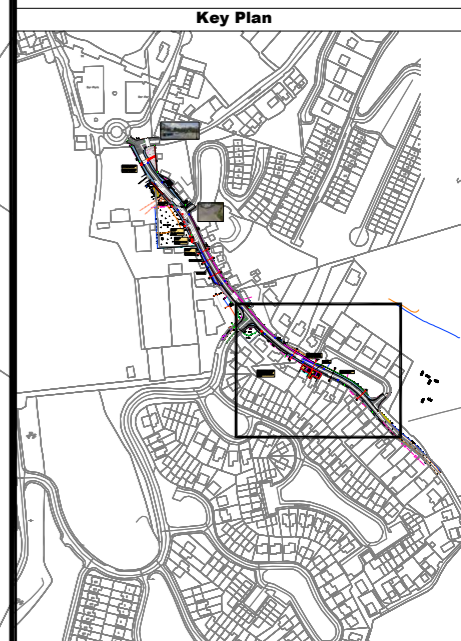

Rev	By	Date	Description

Drawing Status: DISCUSSION
NOT CERTIFIED FOR CONSTRUCTION

Project Title: Church Bay Road, Crosshaven, Cork

Drawing Title: General Layout (3 of 3)

Client: Cork County Council

M.H.L. & Associates Ltd.
Consulting Engineers

Carrig Mór House, Tel: 021-4840214
 10 High Street, Fax: 021-4840215
 Douglas Road, E-Mail: info@mhl.ie
 Cork

Designed: FOS	Drawn: FOS	Checked: KM
Scale: 1/500 @A3	Date: March 2022	
Job No: 21048RD	Drawing No: 21048RD-GL-D03	Revision:

NOTES:
 All dimensions in metres.
 Do not scale from drawing.
 For any discrepancies found please consult with design office.
 This drawing should be read in conjunction with all contract drawings, documents and specifications.

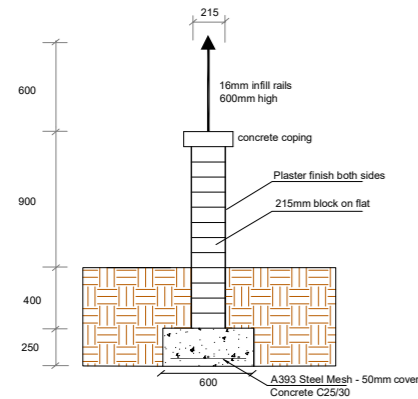

Wall Detail

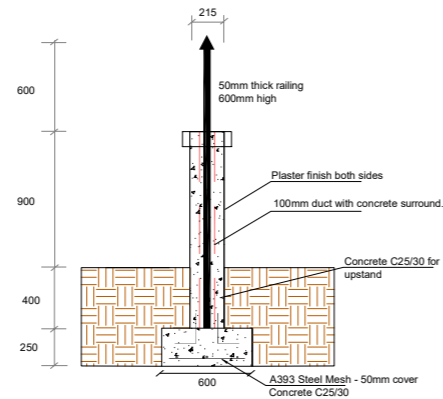

- Notes:**
- 10mm diameter starter bars to be placed in foundation for concrete upstands.
 - 100mm duct to be placed in concrete upstand.
 - Duct to be infilled with concrete once railing is positioned.
 - Upstand to be 400mm in length.

Post Rail Detail

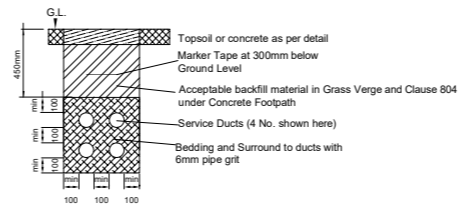

Service Ducts in Footpath/verges Type B

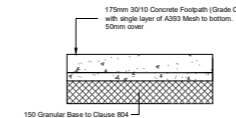

- Notes:**
- Driveway to have steel float finish with textured brush finish. Steel float finish to joints and edges.
 - Expansion/control joints centres two times width. 3m max.
 - All kerbs to be dropped over 1.0m to 25mm above road level at vehicular entrances.

Driveway Construction

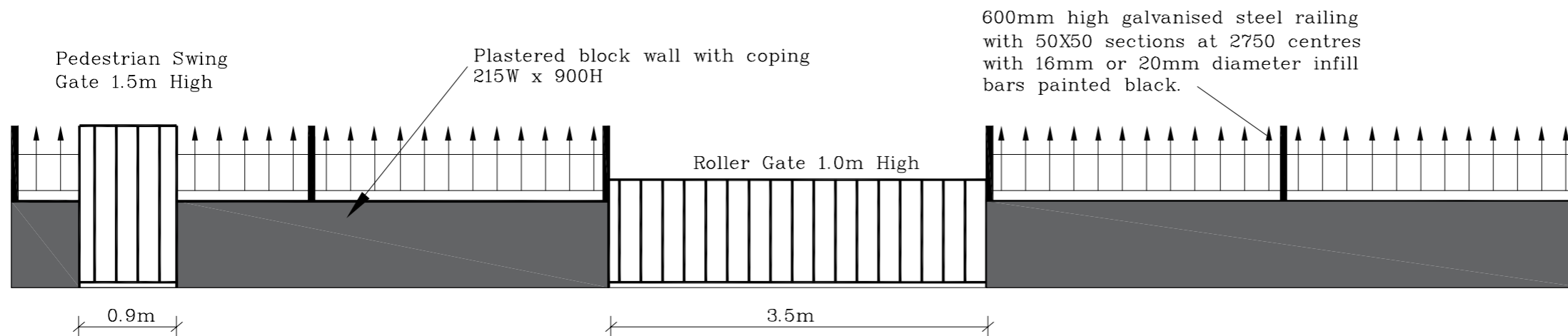

Rev	By	Date	Description
02	FOS	15/10/21	Details altered after meeting.
01	FOS	13/09/21	Gate & wall details altered

Drawing Status: DISCUSSION
 NOT CERTIFIED FOR CONSTRUCTION

Project Title: Church Bay Road, Crosshaven, Cork

Drawing Title: Project Construction Details
 Accommodation Works

Client: Cork County Council

M.H.L. & Associates Ltd.
Consulting Engineers
 Carrig Mór House, Carrig Mór House, Carrig Mór House, Carrig Mór House
 10 High Street, 10 High Street, 10 High Street, 10 High Street
 Douglas Road, Douglas Road, Douglas Road, Douglas Road
 Cork, Cork, Cork, Cork
 Tel: 021-4840214, Fax: 021-4840215, E-Mail: info@mhl.ie

Designed: FOS **Drawn:** FOS **Checked:** KM

Scale: 1/50 @A3 **Date:** Oct 2021

Job No: 21048RD **Drawing No:** 21048RD-PCD-D01 **Revision:** 02

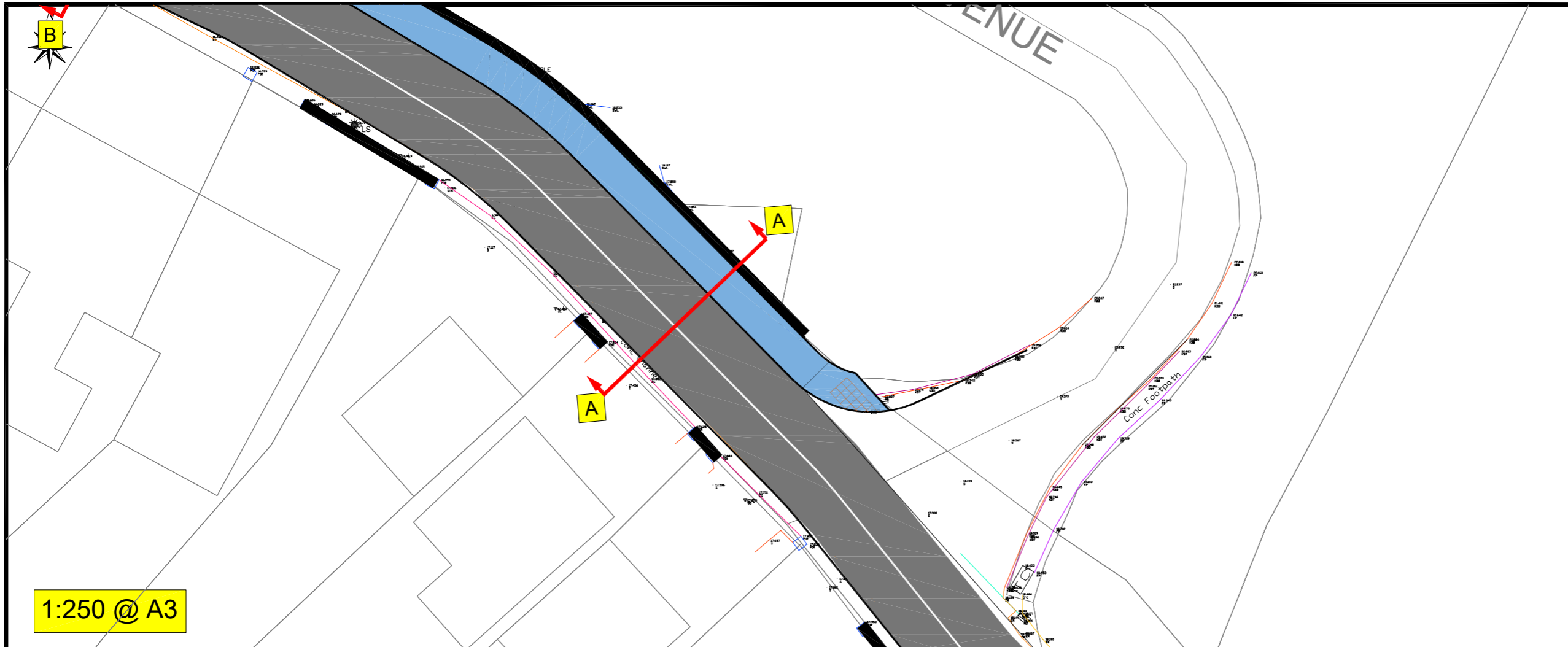

1:250 @ A3

NOTES:
 All dimensions in metres.
 Do not scale from drawing.
 For any discrepancies found please consult with design office.
 This drawing should be read in conjunction with all contract drawings, documents and specifications.

LEGEND:

- Existing carriageway
- Existing footpath
- Proposed footpath/buildout
- Existing footpath area to be broken out and replaced to suit new levels
- Proposed road signs

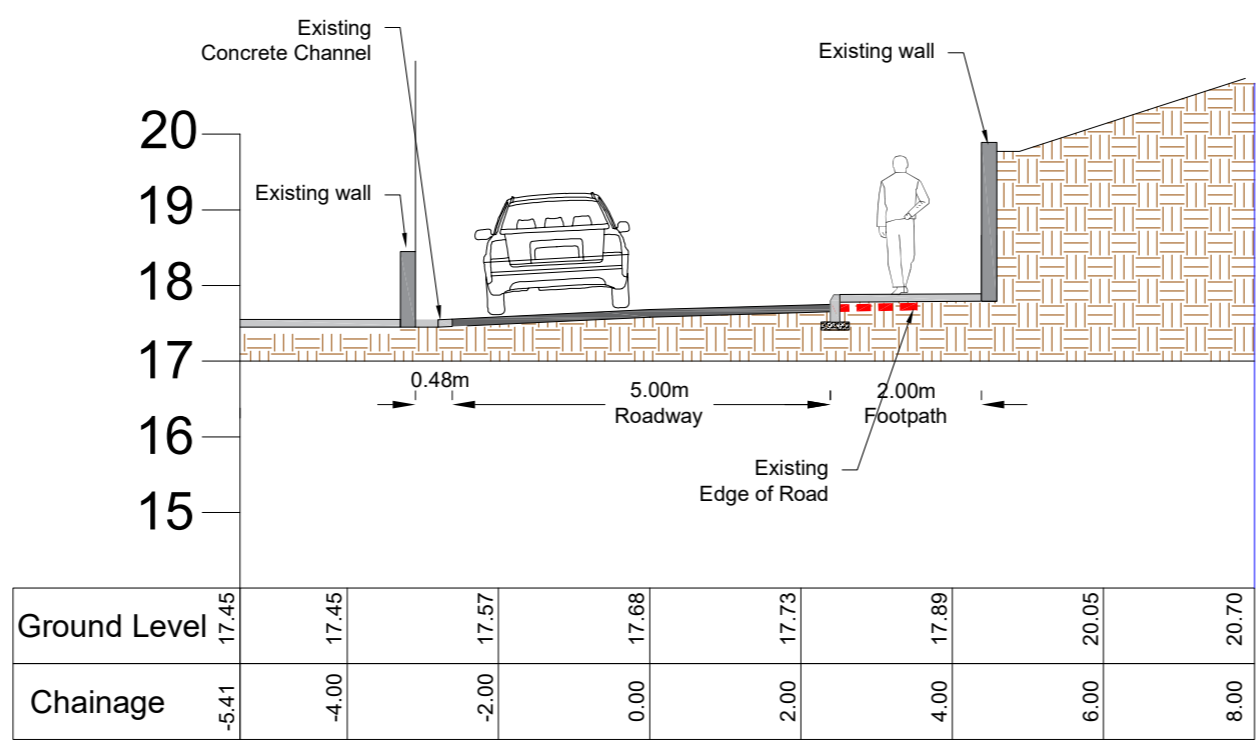
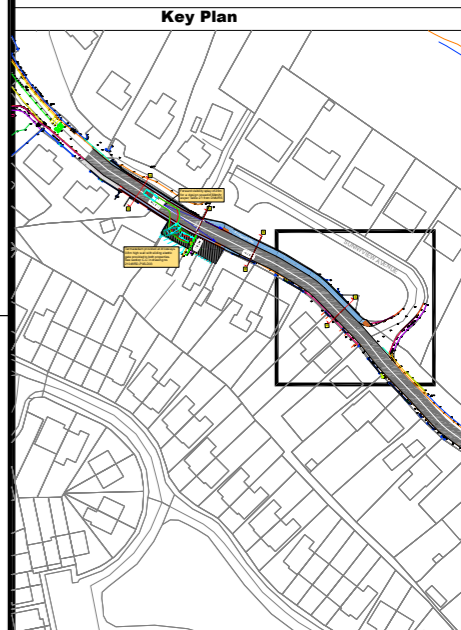

Section A-A

1:100 @ A3

Rev	By	Date	Description
02	FOS	28/05/21	Road width changed to 5.0m
01	FOS	13/05/21	Road width changed to 4.8m

Drawing Status: DISCUSSION
NOT CERTIFIED FOR CONSTRUCTION

Project Title: Church Bay Road, Crosshaven, Cork

Drawing Title: Proposed Cross Sections

Client: Cork County Council

M.H.L & Associates Ltd.
 Consulting Engineers

Carrig Mór House,
 10 High Street,
 Douglas Road,
 Cork

Tel: 021-4840214
 Fax: 021-4840215
 E-Mail: info@mhl.ie

Designed: FOS	Drawn: SFM	Checked: KM
Scale: As Shown @A3	Date: May 2021	
Job No: 21048RD	Drawing No: 21048RD-PXS-D01	Revision: 02

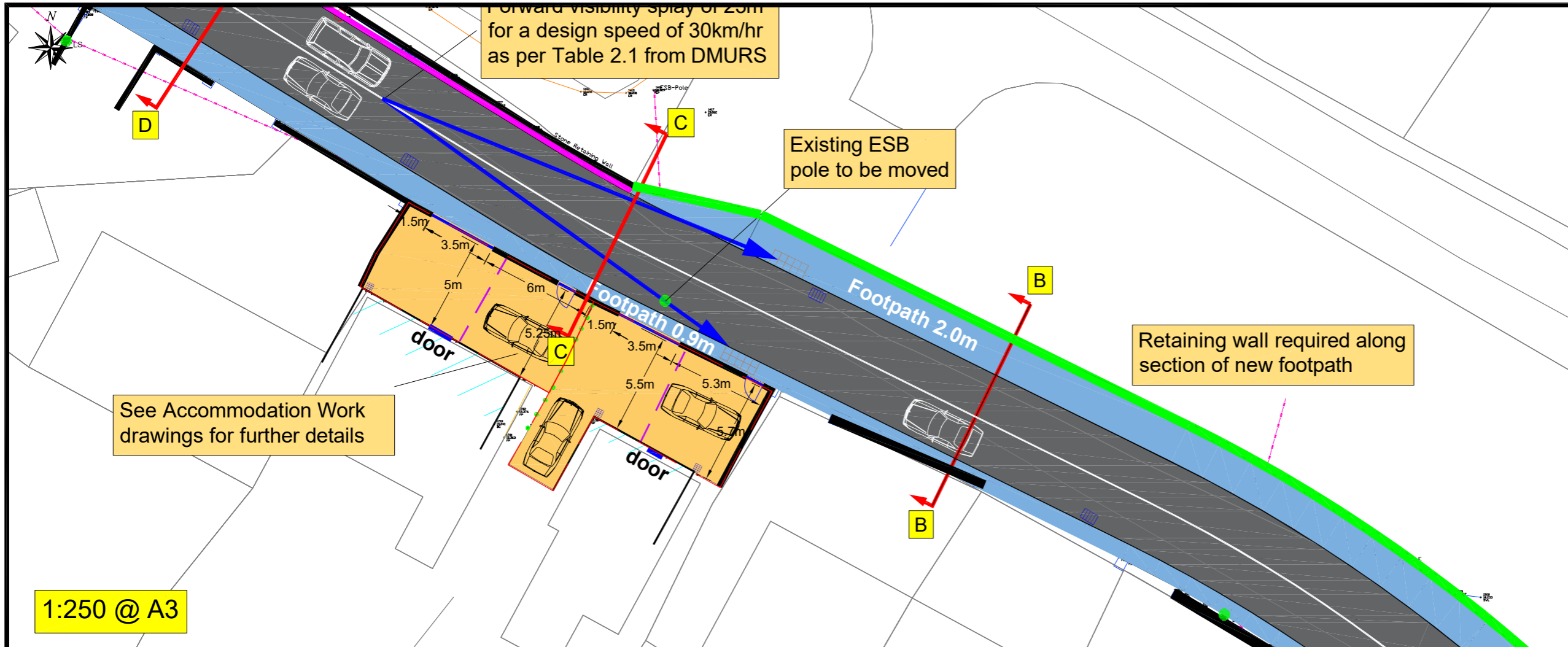

1:250 @ A3

NOTES:
 All dimensions in metres.
 Do not scale from drawing.
 For any discrepancies found please consult with design office.
 This drawing should be read in conjunction with all contract drawings, documents and specifications.

LEGEND:

- Existing carriageway
- Existing footpath
- Proposed footpath/buildout
- Existing footpath area to be broken out and replaced to suit new levels
- Proposed road signs

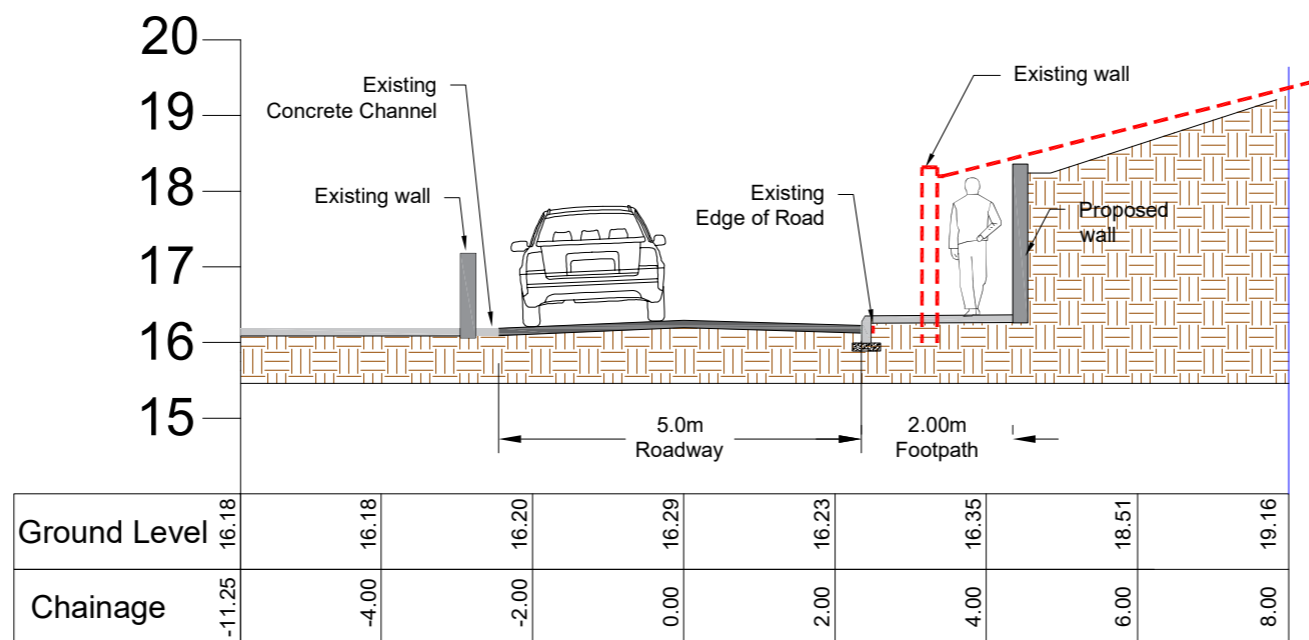
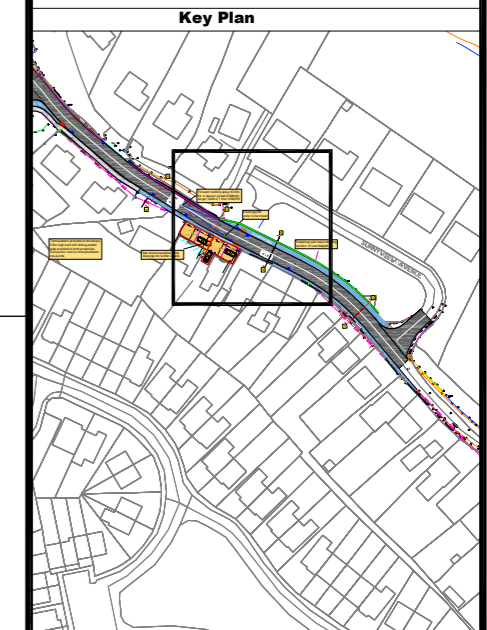

Section B-B

1:100 @ A3

Rev	By	Date	Description
02	FOS	28/05/21	Road width changed to 5.0m
01	FOS	13/05/21	Road width changed to 4.8m

Drawing Status: DISCUSSION
NOT CERTIFIED FOR CONSTRUCTION

Project Title: Church Bay Road, Crosshaven, Cork

Drawing Title: Proposed Cross Sections

Client: Cork County Council

M.H.L & Associates Ltd.
Consulting Engineers

Carrig Mór House,
 10 High Street,
 Douglas Road,
 Cork

Tel: 021-4840214
 Fax: 021-4840215
 E-Mail: info@mhl.ie

Designed: FOS	Drawn: SFM	Checked: KM
Scale: As Shown @A3	Date: May 2021	
Job No: 21048RD	Drawing No: 21048RD-PXS-D02	Revision: 02

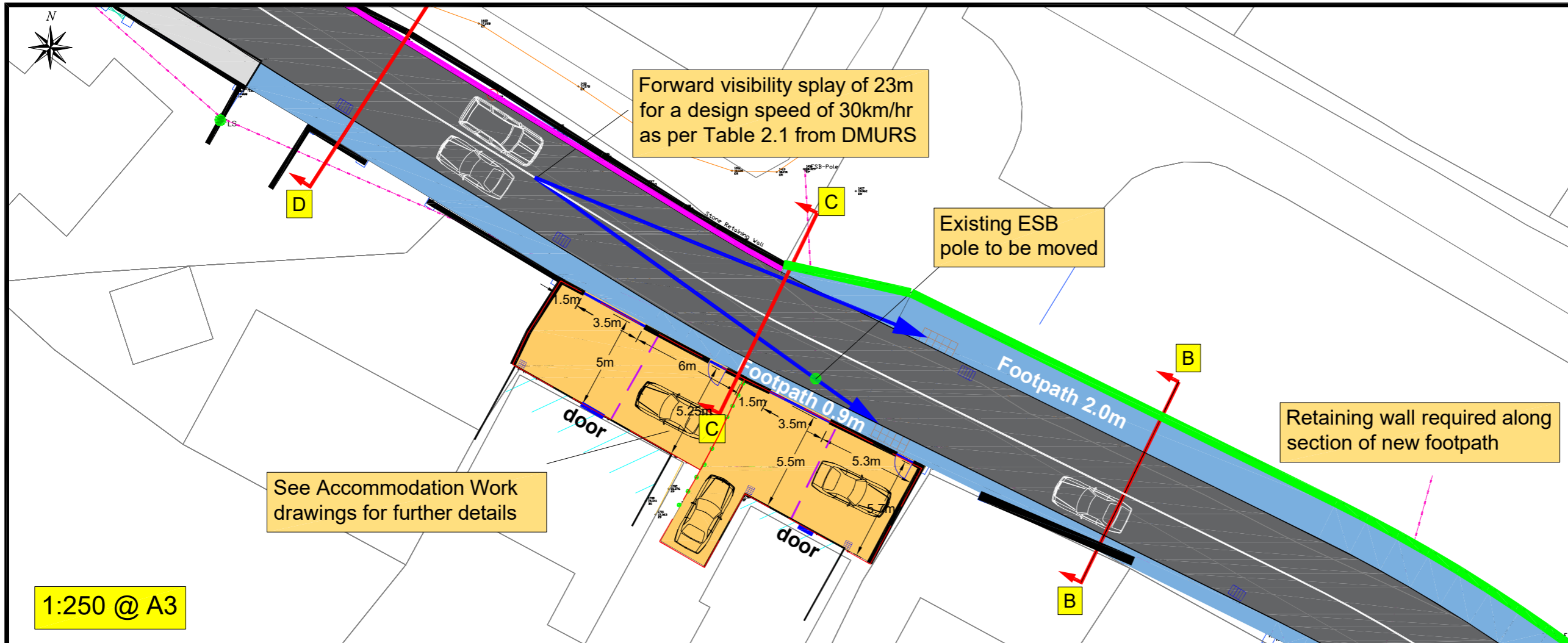

1:250 @ A3

NOTES:
 All dimensions in metres.
 Do not scale from drawing.
 For any discrepancies found please consult with design office.
 This drawing should be read in conjunction with all contract drawings, documents and specifications.

LEGEND:

- Existing carriageway
- Existing footpath
- Proposed footpath/buildout
- Existing footpath area to be broken out and replaced to suit new levels

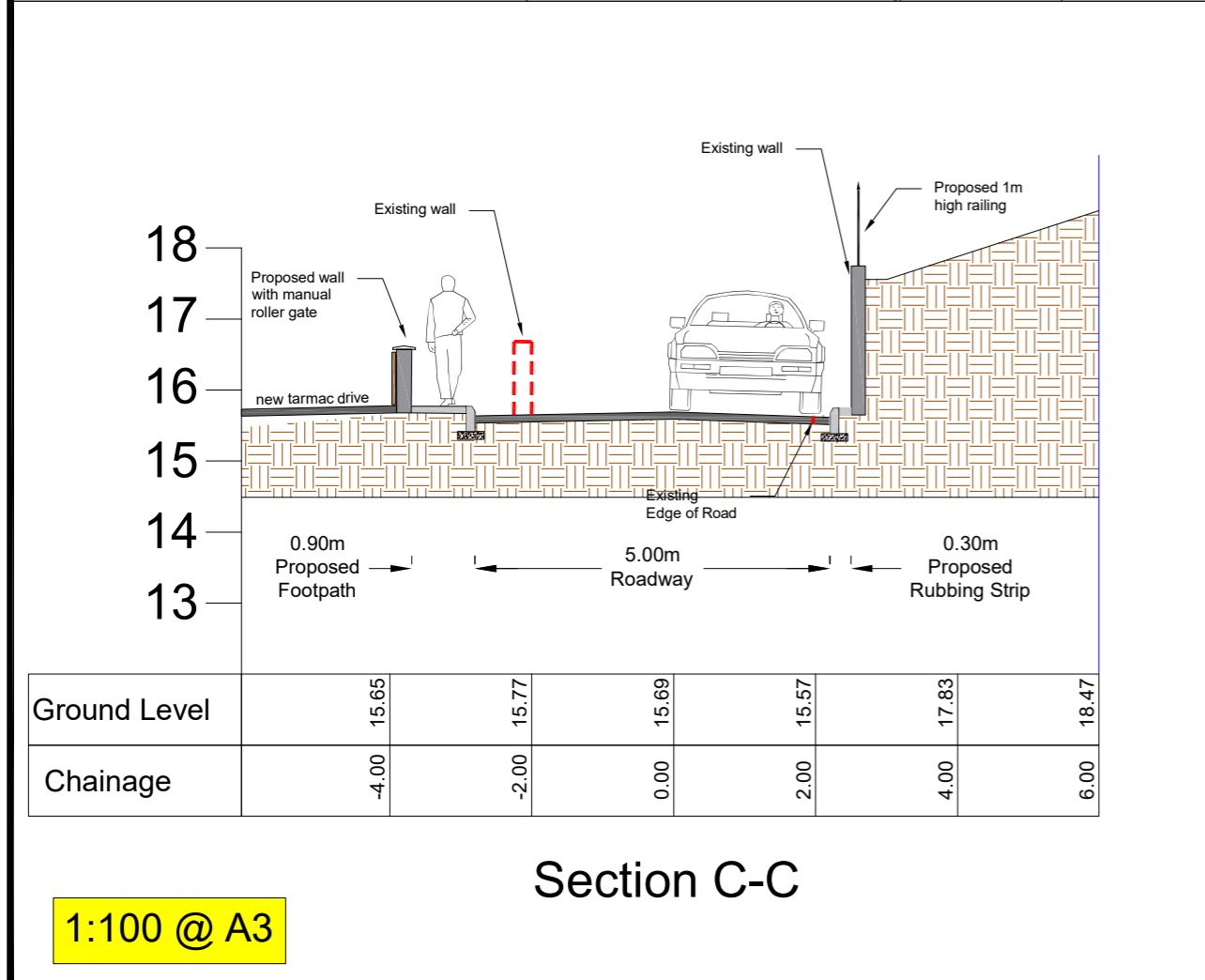

Section C-C

1:100 @ A3

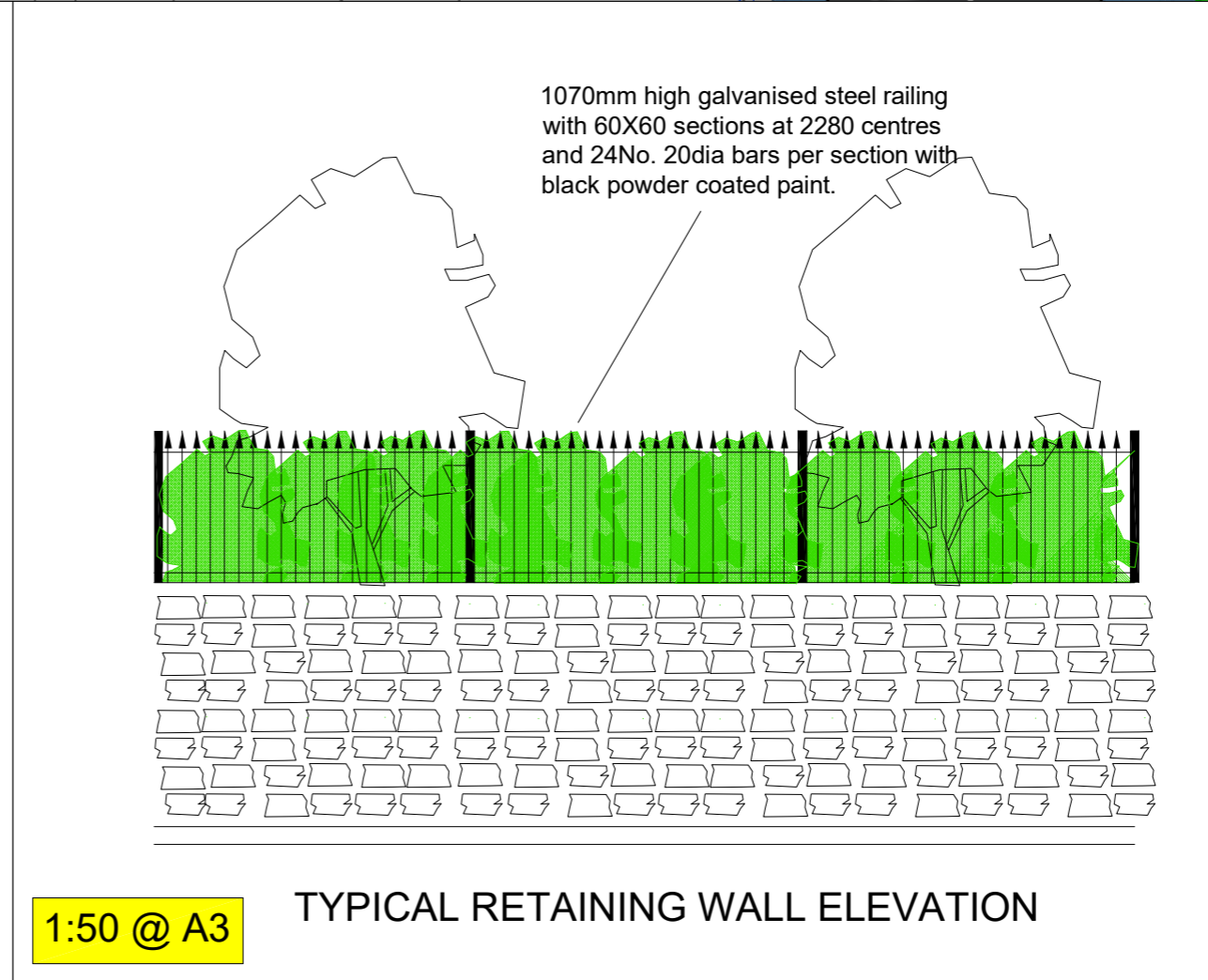

TYPICAL RETAINING WALL ELEVATION

1:50 @ A3

Rev	By	Date	Description
04	FOS	13/07/21	Accomodation works updated.
03	FOS	03/06/21	Road widened to 5m. Accomodation works included
02	FOS	13/05/21	Road width changed to 3.5m at Yield system
01	FOS	13/05/21	Road width changed to 4.8m

Drawing Status: DISCUSSION
NOT CERTIFIED FOR CONSTRUCTION

Project Title: Church Bay Road, Crosshaven, Cork

Drawing Title: Proposed Cross Sections

Client: Cork County Council

M.H.L. & Associates Ltd.
Consulting Engineers
 Carrig Mór House,
 10 High Street,
 Douglas Road,
 Cork
 Tel: 021-4840214
 Fax: 021-4840215
 E-Mail: info@mhl.ie

Designed: FOS	Drawn: SFM	Checked: KM
Scale: As Shown @A3	Date: July 2021	
Job No: 21048RD	Drawing No: 21048RD-PXS-D03	Revision: 04

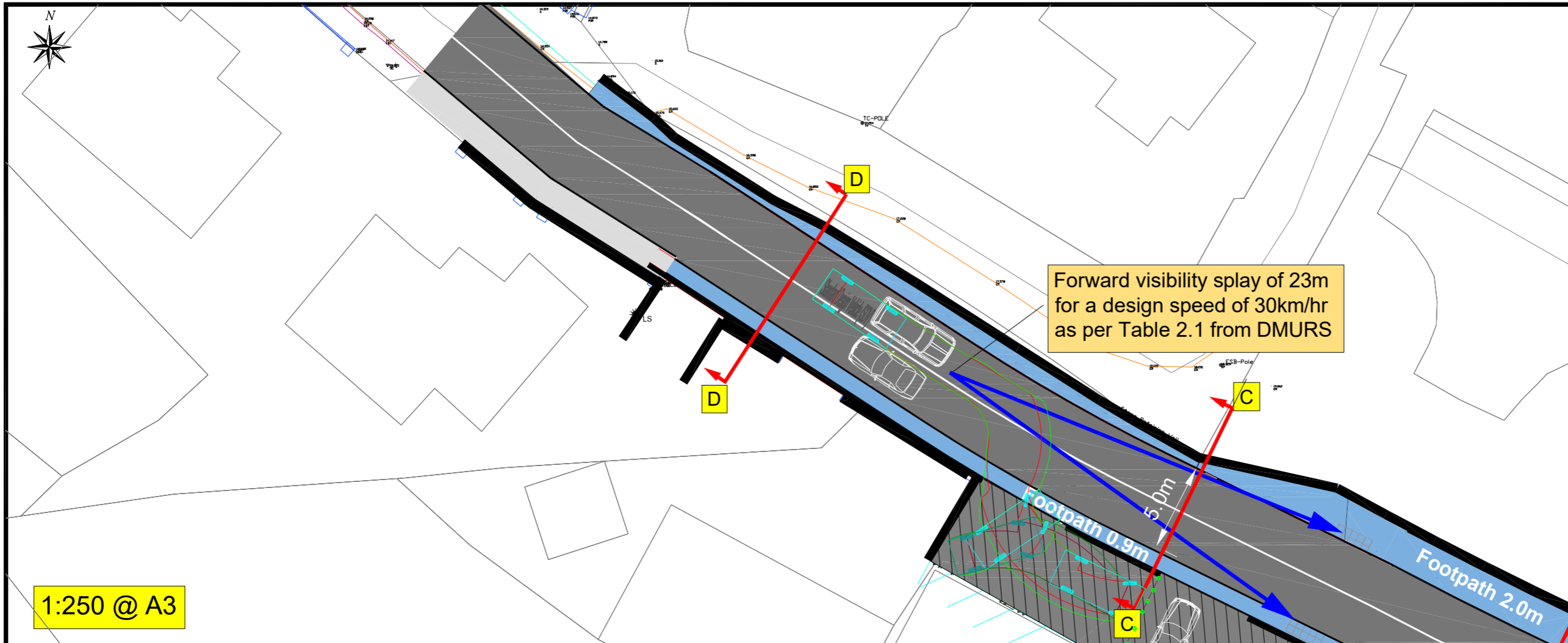

1:250 @ A3

- NOTES:**
 All dimensions in metres.
 Do not scale from drawing.
 For any discrepancies found please consult with design office.
 This drawing should be read in conjunction with all contract drawings, documents and specifications.
- LEGEND:**
- Existing carriageway
 - Existing footpath
 - Proposed footpath/buildout
 - Existing footpath area to be broken out and replaced to suit new levels
 - Proposed road signs

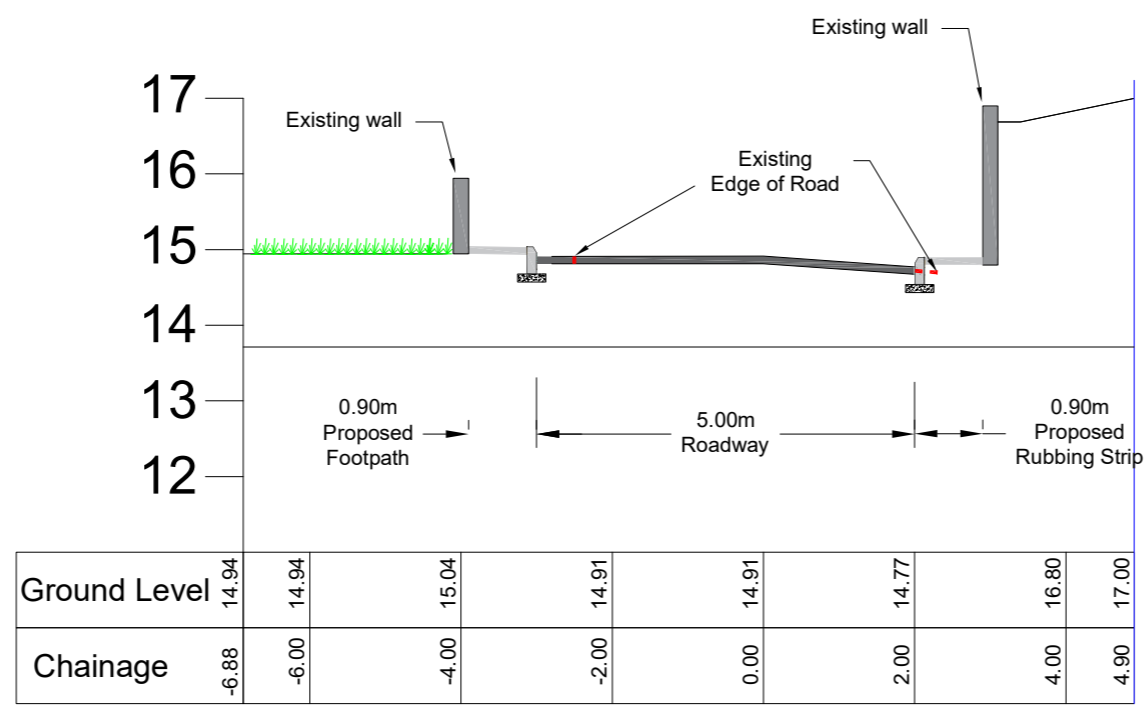

Section D-D

1:100 @ A3

Rev	By	Date	Description
02	FOS	28/05/21	Road width changed to 5.0m
01	FOS	13/05/21	Road width changed to 4.8m

Drawing Status: DISCUSSION
NOT CERTIFIED FOR CONSTRUCTION

Project Title: Church Bay Road, Crosshaven, Cork

Drawing Title: Proposed Cross Sections

Client: Cork County Council

M.H.L. & Associates Ltd.
 Consulting Engineers

Carrig Mór House,
 10 High Street,
 Douglas Road,
 Cork

Tel: 021-4840214
 Fax: 021-4840215
 E-Mail: info@mhl.ie

Designed: FOS	Drawn: SFM	Checked: KM
Scale: As Shown @A3	Date: May 2021	
Job No: 21048RD	Drawing No: 21048RD-PXS-D04	Revision: 02

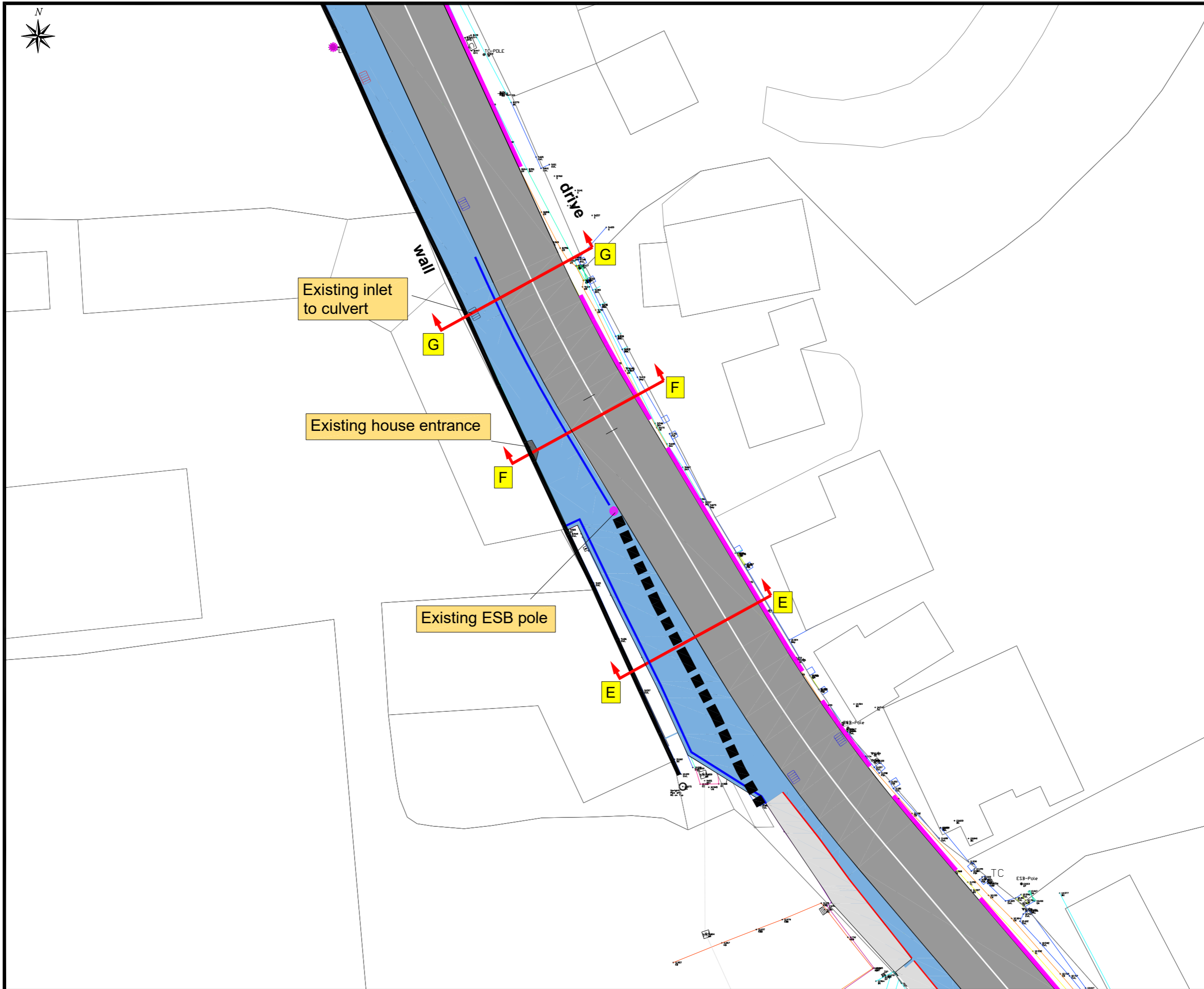

NOTES:
 All dimensions in metres.
 Do not scale from drawing.
 For any discrepancies found please consult with design office.
 This drawing should be read in conjunction with all contract drawings, documents and specifications.

- LEGEND:**
- Existing carriageway
 - Existing footpath
 - Proposed footpath/buildout
 - Existing wall to be removed
 - Proposed pedestrian railing as per 21048RD-PCD-D01 & CC-SCD-00401
 - Proposed 300mm wide cast in situ concrete rubbing strip
 - Existing gully to be removed
 - Proposed road gully
- Please see drawing 21084RD-CXS-D01 for cross sections at cottage.

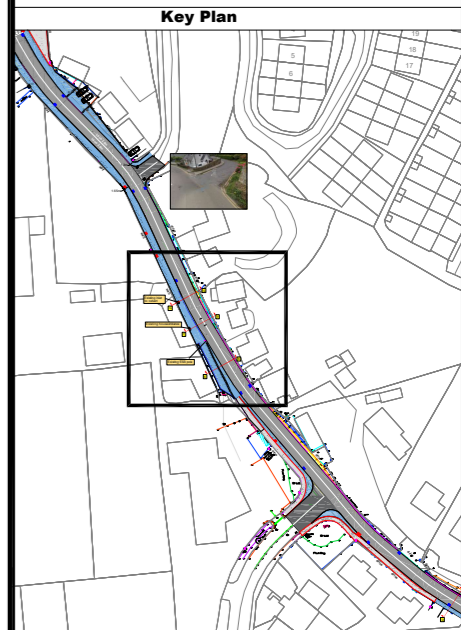

Rev	By	Date	Description
01	FOS	13/09/21	Wall removed, railing added. Cross sections added.

Drawing Status: DISCUSSION
NOT CERTIFIED FOR CONSTRUCTION

Project Title: Church Bay Road, Crosshaven, Cork

Drawing Title: Proposed Cross Sections

Client: Cork County Council

M.H.L & Associates Ltd.
Consulting Engineers

Carrig Mór House,
 10 High Street,
 Douglas Road,
 Cork

Tel: 021-4840214
 Fax: 021-4840215
 E-Mail: info@mhl.ie

Designed: FOS	Drawn: FOS	Checked: KM
----------------------	-------------------	--------------------

Scale: 1:250 @A3 **Date:** Sept 2021

Job No: 21048RD	Drawing No: 21048RD-PXS-D05	Revision: 01
------------------------	------------------------------------	---------------------