

Cork County Council



L2021 Upper Mahoney Avenue NTA Towns & Villages, Active Travel Measures

Section 38 Road Traffic Act, 1994

Drawing Schedule

Drawing No.	Drawing Title	Rev.	Scale	Size
L2021-LM-01	Location Map	01	NTS	A3
L2021-LA-01	Proposed Layout Plan - Sheet 1 of 2	01	1:250	A3
L2021-LA-02	Proposed Layout Plan - Sheet 2 of 2	01	1:500	A3

Bandon Area Office

Cork County Council,

Railway Place

Bandon

Cork, P72XK59

Section 38

June 2022

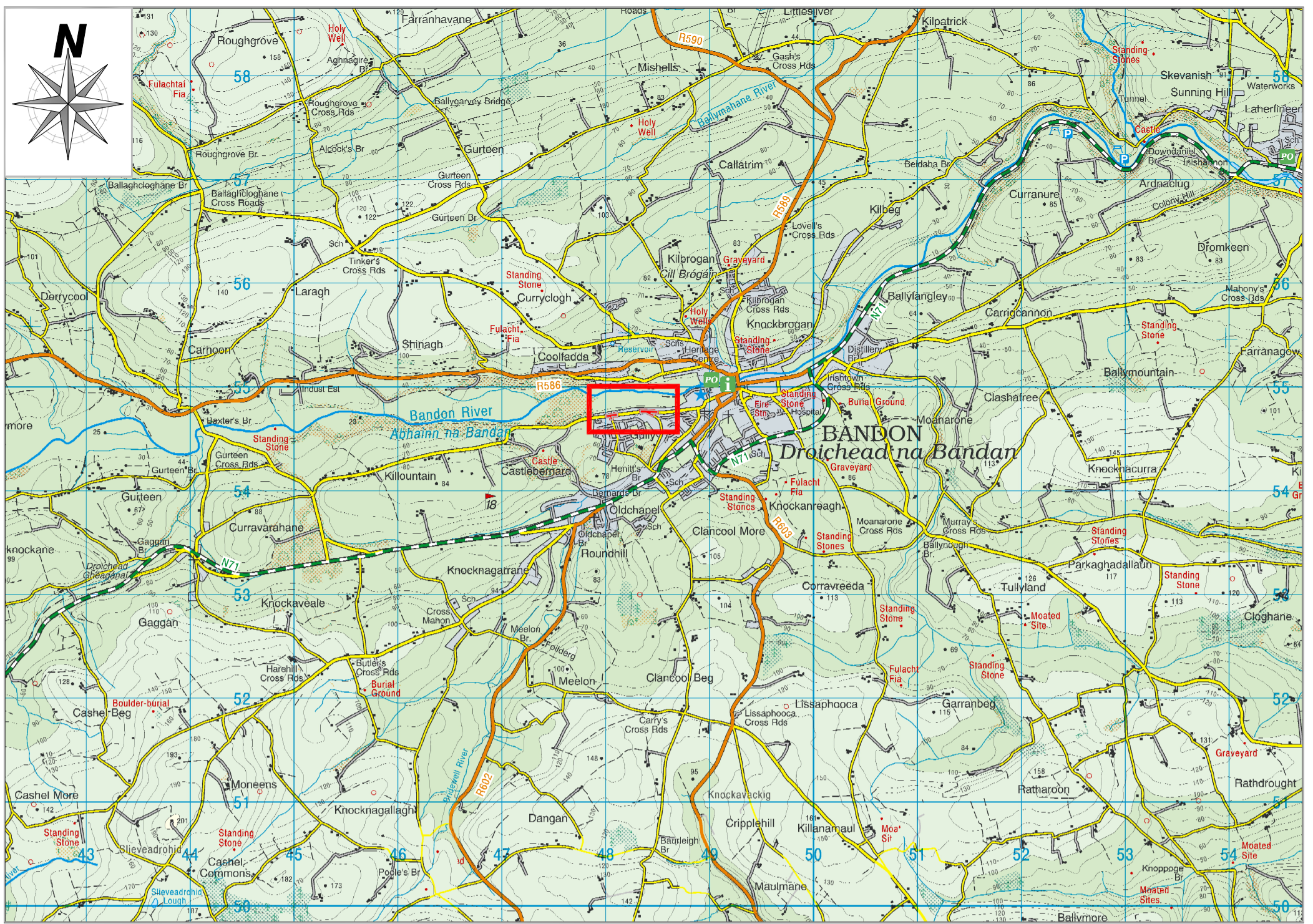

Not to Scale

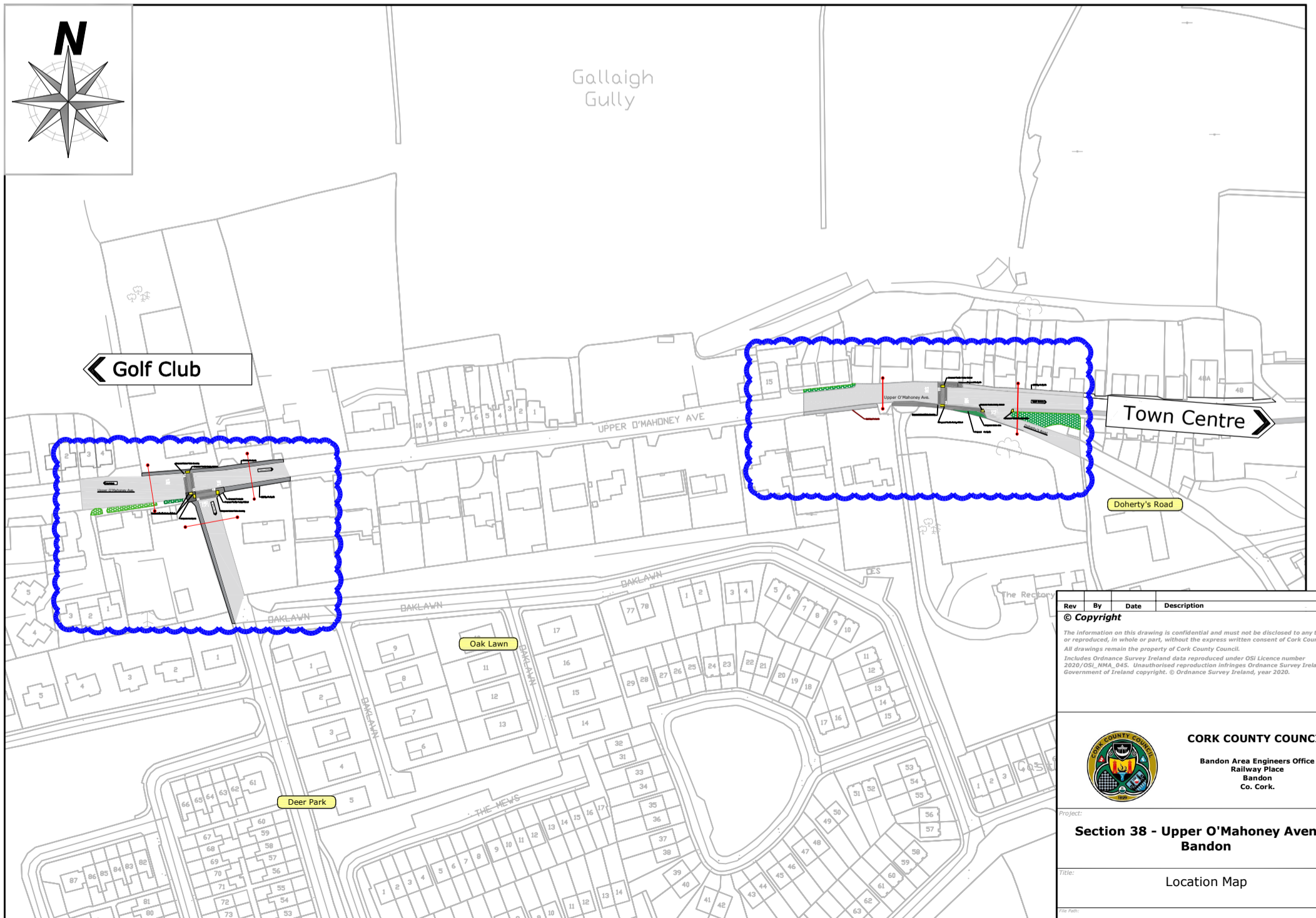

Not to Scale

Rev	By	Date	Description
1		16/06/2022	Not to scale
2		16/06/2022	Not to scale
3		16/06/2022	Not to scale
4		16/06/2022	Not to scale
5		16/06/2022	Not to scale
6		16/06/2022	Not to scale
7		16/06/2022	Not to scale
8		16/06/2022	Not to scale
9		16/06/2022	Not to scale
10		16/06/2022	Not to scale
11		16/06/2022	Not to scale
12		16/06/2022	Not to scale
13		16/06/2022	Not to scale
14		16/06/2022	Not to scale
15		16/06/2022	Not to scale
16		16/06/2022	Not to scale
17		16/06/2022	Not to scale
18		16/06/2022	Not to scale
19		16/06/2022	Not to scale
20		16/06/2022	Not to scale
21		16/06/2022	Not to scale
22		16/06/2022	Not to scale
23		16/06/2022	Not to scale
24		16/06/2022	Not to scale
25		16/06/2022	Not to scale
26		16/06/2022	Not to scale
27		16/06/2022	Not to scale
28		16/06/2022	Not to scale
29		16/06/2022	Not to scale
30		16/06/2022	Not to scale
31		16/06/2022	Not to scale
32		16/06/2022	Not to scale
33		16/06/2022	Not to scale
34		16/06/2022	Not to scale
35		16/06/2022	Not to scale
36		16/06/2022	Not to scale
37		16/06/2022	Not to scale
38		16/06/2022	Not to scale
39		16/06/2022	Not to scale
40		16/06/2022	Not to scale
41		16/06/2022	Not to scale
42		16/06/2022	Not to scale
43		16/06/2022	Not to scale
44		16/06/2022	Not to scale
45		16/06/2022	Not to scale
46		16/06/2022	Not to scale
47		16/06/2022	Not to scale
48		16/06/2022	Not to scale
49		16/06/2022	Not to scale
50		16/06/2022	Not to scale
51		16/06/2022	Not to scale
52		16/06/2022	Not to scale
53		16/06/2022	Not to scale
54		16/06/2022	Not to scale
55		16/06/2022	Not to scale
56		16/06/2022	Not to scale
57		16/06/2022	Not to scale
58		16/06/2022	Not to scale
59		16/06/2022	Not to scale
60		16/06/2022	Not to scale
61		16/06/2022	Not to scale
62		16/06/2022	Not to scale
63		16/06/2022	Not to scale
64		16/06/2022	Not to scale
65		16/06/2022	Not to scale
66		16/06/2022	Not to scale
67		16/06/2022	Not to scale
68		16/06/2022	Not to scale
69		16/06/2022	Not to scale
70		16/06/2022	Not to scale
71		16/06/2022	Not to scale
72		16/06/2022	Not to scale
73		16/06/2022	Not to scale
74		16/06/2022	Not to scale
75		16/06/2022	Not to scale
76		16/06/2022	Not to scale
77		16/06/2022	Not to scale
78		16/06/2022	Not to scale
79		16/06/2022	Not to scale
80		16/06/2022	Not to scale
81		16/06/2022	Not to scale
82		16/06/2022	Not to scale
83		16/06/2022	Not to scale
84		16/06/2022	Not to scale
85		16/06/2022	Not to scale
86		16/06/2022	Not to scale
87		16/06/2022	Not to scale
88		16/06/2022	Not to scale
89		16/06/2022	Not to scale
90		16/06/2022	Not to scale
91		16/06/2022	Not to scale
92		16/06/2022	Not to scale
93		16/06/2022	Not to scale
94		16/06/2022	Not to scale
95		16/06/2022	Not to scale
96		16/06/2022	Not to scale
97		16/06/2022	Not to scale
98		16/06/2022	Not to scale
99		16/06/2022	Not to scale
100		16/06/2022	Not to scale

Copyright
 The information on this drawing is confidential and must not be disclosed to any third party or reproduced, in whole or part, without the express written consent of Cork County Council. All drawings remain the property of Cork County Council.
 Includes Ordnance Survey Ireland data reproduced under OSI Licence number 2020/OSI_NMA_045. Unauthorised reproduction infringes Ordnance Survey Ireland and Government of Ireland copyright. © Ordnance Survey Ireland, year 2020.

CORK COUNTY COUNCIL
 Bandon Area Engineers Office
 Railway Place
 Bandon
 Co. Cork.

Project: **Section 38 - Upper O'Mahoney Avenue, Bandon**

Title: **Location Map**

16 June 2022
 Approved

L2021-LM-01



LEGEND

- Existing road
- Existing footpath
- Existing green area
- Proposed Footpath width 2.0m where possible
- Proposed green area
- Proposed ramp or raised table crossing
- Proposed Tactile Paving (Yellow)
- Extent of proposed scheme

Notes

- 1 All dimensions in metres unless otherwise stated.
- 2 The information shown on this plan is a general guide and the accuracy thereof cannot be guaranteed. No liability is accepted for any discrepancy, omission or deviation and the actual position of services and underground plant must be established on site before any mechanical excavation is undertaken.
- 3 Uncontrolled Pedestrian Crossings: Crossings to be constructed as per the "Traffic Management Guidelines" (TMG 2003) and include grey or buff tactile slabs. Kerbs are to be dropped along full length of tactile slabs.
- 4 Dimensions not to be scaled from drawing. Any queries to be conveyed to the CCC Road Design Office, Floor 3, County Library Building.

Rev **By** **Date** **Description**

@ Copyright

The information on this drawing is confidential and must not be disclosed to any third party or reproduced, in whole or part, without the express written consent of Cork County Council. All drawings remain the property of Cork County Council.

Includes Ordnance Survey Ireland data reproduced under OS Licence number 100049256. Ordnance Survey Ireland is a registered trademark of Ordnance Survey Ireland, a Government of Ireland copyright. © Ordnance Survey Ireland, year 2020.

CORK COUNTY COUNCIL
 Bandon Area Engineers Office
 Railway Place
 Co. Cork

PROJECT
Section 38 - O'Mahoney Avenue, Bandon

TITLE
 Proposed Layout Plan Sheet 1 of 2

DATE	BY	CHKD	APPD
18th May 2022	HK	RC	RC
1:250	1:250	1:250	1:250

L2021-LA-01 **01**

Approved

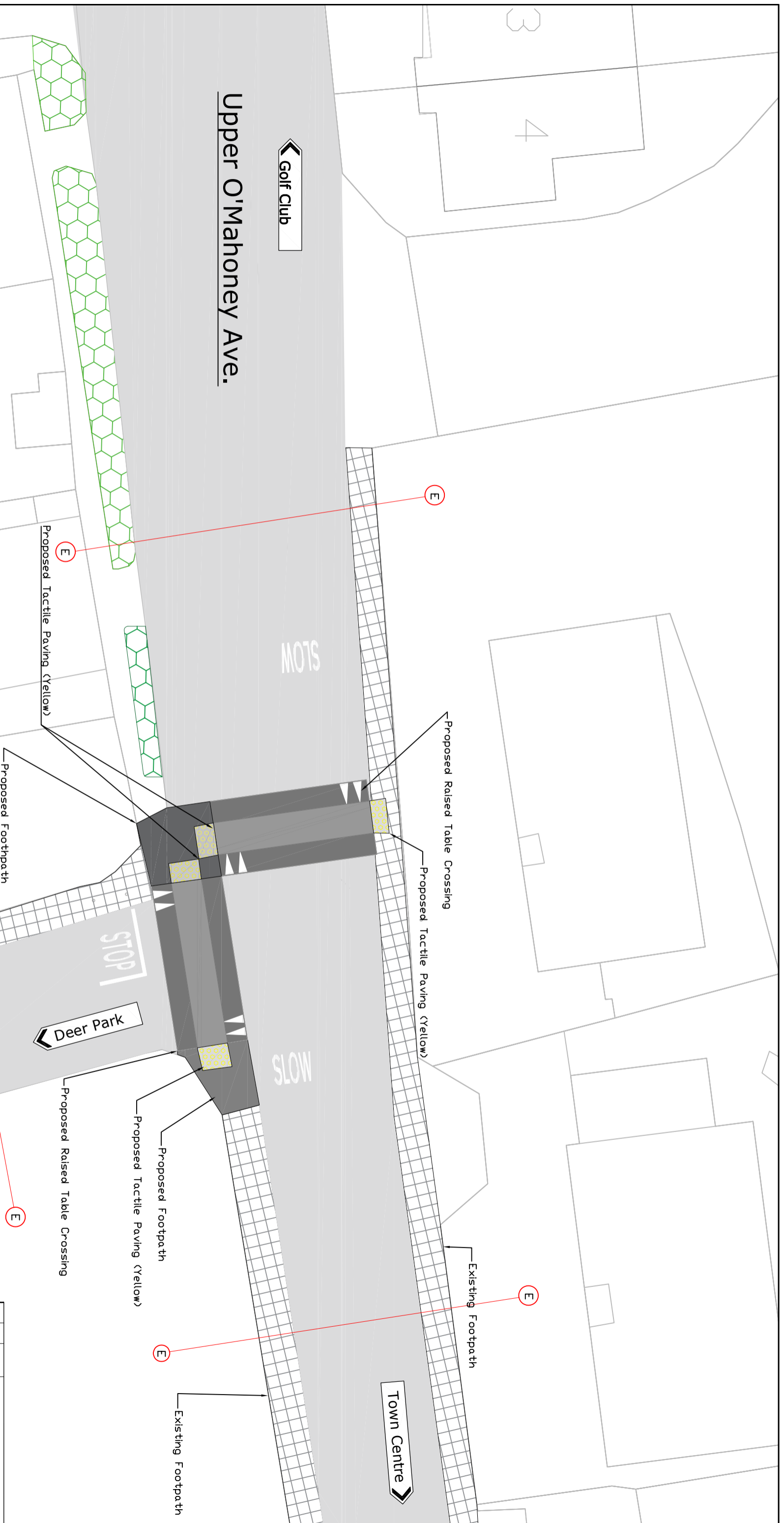

Upper O'Mahoney Ave.

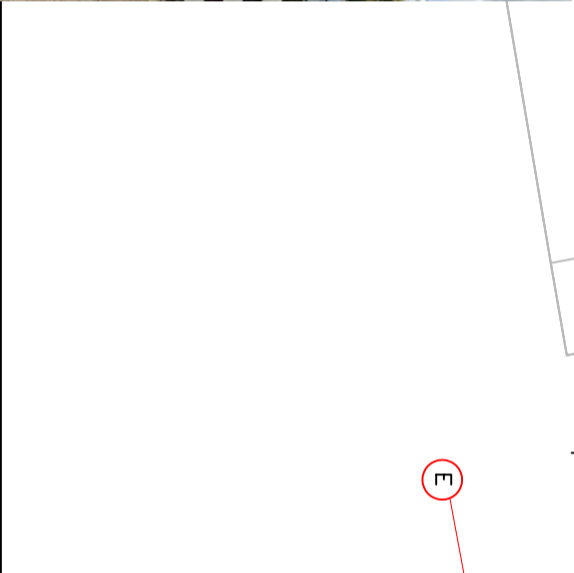

- NOTES**
- 1 All dimensions in metres unless otherwise stated.
 - 2 The information shown on this plan is a general guide and the accuracy thereof cannot be guaranteed. No liability is accepted for any discrepancy, omission or deviation and the actual position of services and underground plant must be established on site before any mechanical excavation is undertaken.
 - 3 Uncontrolled Pedestrian Crossings: Crossings to be constructed as per the "Traffic Management Guidelines" (TMC 2003) and include grey or buff tactile slabs. Kerbs are to be dropped along full length of tactile slabs.
 - 4 Dimensions not to be scaled from drawing. Any queries to be conveyed to the CCC Road Design Office, Floor 3, County Library Building.

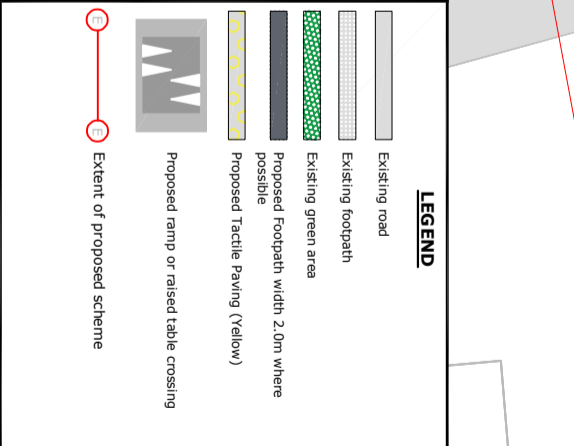

Rev	By	Date	Description
01			

© Copyright
 The information on this drawing is confidential and must not be disclosed to any third party or reproduced, in whole or part, without the express written consent of Cork County Council. All drawings remain the property of Cork County Council.
 Includes Ordnance Survey Ireland data reproduced under OS Licence number 100049278. © Ordnance Survey Ireland, year 2020.

CORK COUNTY COUNCIL
 Bandon Ave Engineers Office
 Railway Place
 Bandon
 Co. Cork

Project:
Section 38 - Upper O'Mahoney Avenue, Bandon

Title:
Proposed Layout Plan Sheet 2 of 2

16 June 2022	Approved	18.05.2022	1:200	A3
--------------	----------	------------	-------	----

Approved

2021 - LA - 02

01