

File name: \\EU-AECOM\NET\COM\EM\UK\WORK\UOB\SR-450418_BANDON_TPREP\900_CAD_GIS\910_CAD\25-SKETCHES\SCHOOL_ZONES\GAELSCOIL DROICHEAD NA BANNDAN\20-SHEET\SR60628497_SHT_30_SK_SZ_100.DWG
Last saved by: KEVIN OSULLIVAN Last Plotted: 2022-06-22

Project Management Initials: Designer: KOS Checked: MC Approved: EOM ISO A1 594mm x 841mm

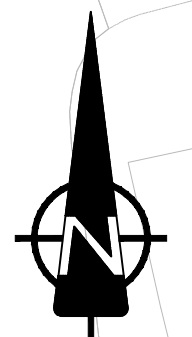

This drawing has been prepared for the use of AECOM's client. It may not be used, modified, reproduced or relied upon by third parties, except as agreed by AECOM or as required by law. AECOM accepts no responsibility, and denies any liability, whatsoever, to any party that uses or relies on this drawing without AECOM's express written consent. All measurements must be obtained from the stated dimensions.

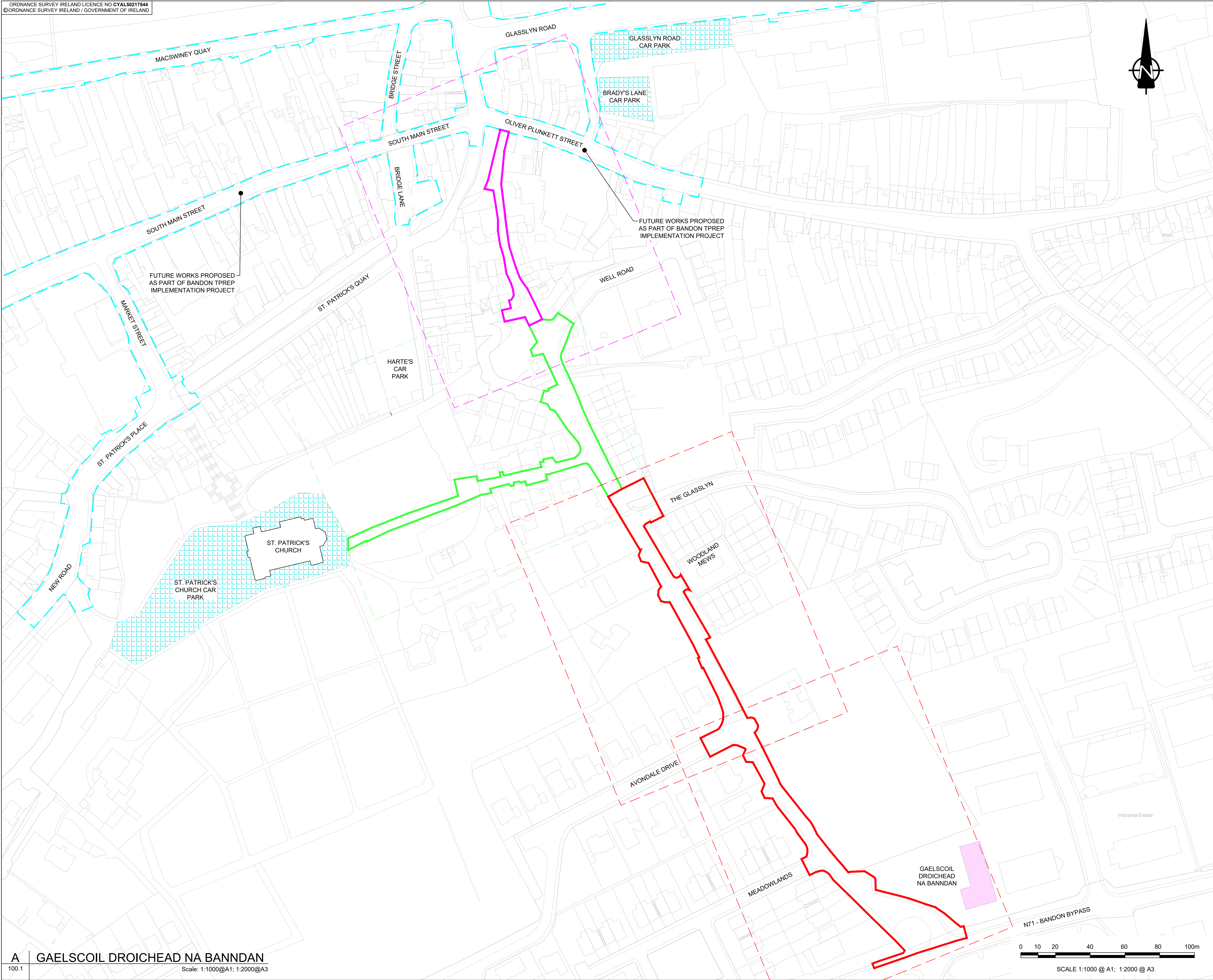

PROJECT

PEDESTRIAN
ACCESSIBILITY
IMPROVEMENTS TO
GAELSCOIL DROICHEAD
NA BANNDAN

CLIENT



CONSULTANT

AECOM
DOUGLAS BUSINESS CENTRE
CARRIGALINE ROAD
DOUGLAS
CORK
Tel: +353 (0)21 436 5006
www.aecom.com

NOTES

1. THIS DRAWING IS TO BE READ IN CONJUNCTION WITH ALL OTHER RELEVANT ENGINEERING DRAWINGS, ANY DISCREPANCIES, ERRORS OR OMISSIONS TO BE BROUGHT TO THE ATTENTION OF THE EMPLOYER.
2. ALL DIMENSIONS TO BE CHECKED BY THE CONTRACTOR ON SITE PRIOR TO COMMENCEMENT OF WORKS.
3. EMPLOYER'S REPRESENTATIVE TO BE INFORMED BY THE CONTRACTOR OF ANY DISCREPANCIES PRIOR TO THE COMMENCEMENT OF WORKS ON SITE.
4. DIMENSIONS OF ALL BOUNDARIES AND ADJOINING ROADS TO BE CHECKED ON SITE PRIOR TO COMMENCEMENT OF WORKS.
5. DO NOT SCALE. ALL MEASUREMENTS AND COORDINATES TO BE CHECKED ON SITE.

KEY:

	EXISTING CAR PARKS
	SEE SHT_140.1 & 2 FOR INTERVENTIONS
	SEE SHT_140.3 FOR INTERVENTIONS
	SEE SHT_140.4 FOR INTERVENTIONS
	BANDON TPREP SCHEME

ISSUE/REVISION

B	MAY 2022	ISSUED FOR INFORMATION
A	MARCH 2022	ISSUED FOR INFORMATION
I/R	DATE	DESCRIPTION

PROJECT NUMBER

60628497

SHEET TITLE

OVERVIEW
GAELSCOIL DROICHEAD NA BANNDAN
SHEET 1 OF 1

SHEET NUMBER

60628497_SHT_30_SK_SZ_100.1

A GAELSCOIL DROICHEAD NA BANNDAN

100.1 Scale: 1:1000@A1; 1:2000@A3

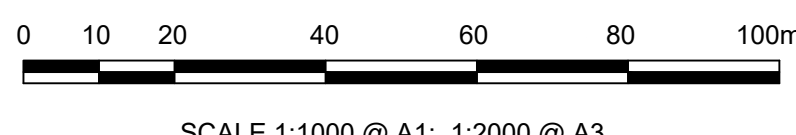



SCHOOL ZONE SCHEME EXAMPLE: SCOIL PHÁDRAIG NAOFA, BANDON, CO.CORK



PROJECT

PEDESTRIAN
ACCESSIBILITY
IMPROVEMENTS TO
GAELSCOIL DROICHEAD
NA BANNDAN

CLIENT



CONSULTANT

AECOM
DOUGLAS BUSINESS CENTRE
CARRIGALINE ROAD
DOUGLAS
CORK
Tel: +353 (0)21 436 5006
www.aecom.com

NOTES

1. THIS DRAWING IS TO BE READ IN CONJUNCTION WITH ALL OTHER RELEVANT ENGINEERING DRAWINGS, ANY DISCREPANCIES, ERRORS OR OMISSIONS TO BE BROUGHT TO THE ATTENTION OF THE EMPLOYER.
2. ALL DIMENSIONS TO BE CHECKED BY THE CONTRACTOR ON SITE PRIOR TO COMMENCEMENT OF WORKS.
3. EMPLOYER'S REPRESENTATIVE TO BE INFORMED BY THE CONTRACTOR OF ANY DISCREPANCIES PRIOR TO THE COMMENCEMENT OF WORKS ON SITE.
4. DIMENSIONS OF ALL BOUNDARIES AND ADJOINING ROADS TO BE CHECKED ON SITE PRIOR TO COMMENCEMENT OF WORKS.
5. DO NOT SCALE. ALL MEASUREMENTS AND COORDINATES TO BE CHECKED ON SITE.

ISSUE/REVISION

C	JUNE 2022	ISSUED FOR SECTION 38
B	MAY 2022	ISSUED FOR SECTION 38
A	MARCH 2022	ISSUED FOR SECTION 38
I/R	DATE	DESCRIPTION

KEY PLAN

PROJECT NUMBER

60628497

SHEET TITLE

GENERAL ARRANGEMENT
GAELSCOIL DROICHEAD NA BANNDAN
SHEET 1 OF 4

SHEET NUMBER

60628497 SHT 30 SK SZ 140.1

Filename: Z:\UK\IEOR\K1\U08SPR-450418_BANDON_TPREP900_CAD_GIS9\0_CAD\25-SKETCHES\SCHOOL_ZONES\GAELSCOIL DROICHEAD NA BANNDAN\20-SHEETS\80628497_SHT_30_SK_SZ_140.DWG
Last saved by: RYAN O'SULLIVAN Last Plotted: 2022-06-27

Project Management Initials: Designer: KOS Checked: MC Approved: EOM ISO A1 594mm x 841mm

ORDNANCE SURVEY IRELAND LICENCE NO CYAL50217544
©ORDNANCE SURVEY IRELAND / GOVERNMENT OF IRELAND

KEY:

PROPOSED CARRIAGEWAY RESURFACING

PROPOSED FOOTWAY

PROPOSED RAISED CROSSING

EXISTING FOOTWAY TO REMAIN

PROPOSED LANDSCAPING

EXISTING CARRIAGEWAY TO REMAIN

EXISTING KERBLINE

PROPOSED BUFF / RED TACTILE

INDICATIVE EXISTING TREE LOCATION

EXISTING RESIDENTIAL ACCESSES

PROPOSED TREE



This drawing has been prepared for the use of AECOM's client. It may not be used, modified, reproduced or relied upon by third parties, except as required by AECOM or as required by law. AECOM accepts no responsibility, and denies any liability whatsoever, to any party that uses or relies on this drawing without AECOM's express written consent. Do not scale this document. All measurements must be obtained from the stated dimensions.



PROJECT

PEDESTRIAN
ACCESSIBILITY
IMPROVEMENTS TO
GAELSCOIL DROICHEAD
NA BANNDAN

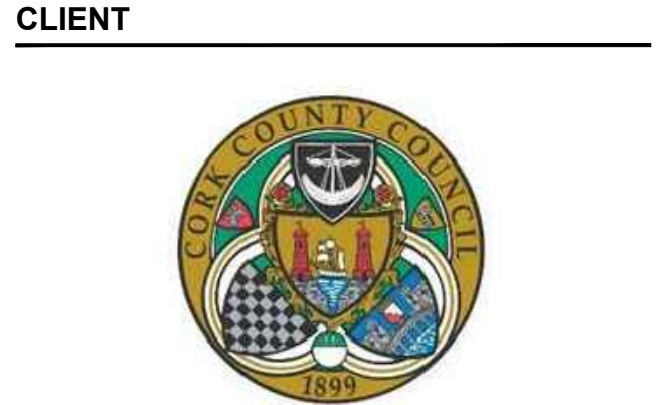

CONSULTANT

AECOM
DOUGLAS BUSINESS CENTRE
CARRIGALINE ROAD
DOUGLAS
CORK
Tel: +353 (0)21 436 5006
www.aecom.com

- NOTES
1. THIS DRAWING IS TO BE READ IN CONJUNCTION WITH ALL OTHER RELEVANT ENGINEERING DRAWINGS. ANY DISCREPANCIES, ERRORS OR OMISSIONS TO BE BROUGHT TO THE ATTENTION OF THE EMPLOYER.
 2. ALL DIMENSIONS TO BE CHECKED BY THE CONTRACTOR ON SITE PRIOR TO COMMENCEMENT OF WORKS.
 3. EMPLOYER'S REPRESENTATIVE TO BE INFORMED BY THE CONTRACTOR OF ANY DISCREPANCIES PRIOR TO THE COMMENCEMENT OF WORKS ON SITE.
 4. DIMENSIONS OF ALL BOUNDARIES AND ADJOINING ROADS TO BE CHECKED ON SITE PRIOR TO COMMENCEMENT OF WORKS.
 5. DO NOT SCALE. ALL MEASUREMENTS AND COORDINATES TO BE CHECKED ON SITE.

ISSUE/REVISION

C	JUNE 2022	ISSUED FOR SECTION 38
B	MAY 2022	ISSUED FOR SECTION 38
A	MARCH 2022	ISSUED FOR SECTION 38
I/R	DATE	DESCRIPTION

KEY PLAN

PROJECT NUMBER

60628497

SHEET TITLE

GENERAL ARRANGEMENT
GAELSCOIL DROICHEAD NA BANNDAN
SHEET 2 OF 4

SHEET NUMBER

60628497_SHT_30_SK_SZ_140.2

Filename: Z:\UK\IEORK\1\08SPR-450418_BANDON_TPREP000_CAD_GIS9\10_CAD\25-SKETCHES\SCHOOL_ZONES\GAELSCOIL DROICHEAD NA BANNDAN\20-SHEETS\60628497_SHT_30_SK_SZ_140.DWG
Last saved by: RYAN.OSULLIVAN Last Plotted: 2022-06-27

Project Management Initials: Designer: KOS Checked: MC Approved: EOM ISO A1 594mm x 841mm

ORDNANCE SURVEY IRELAND LICENCE NO CYAL50217544
©ORDNANCE SURVEY IRELAND / GOVERNMENT OF IRELAND

KEY:

PROPOSED CARRIAGEWAY RESURFACING

PROPOSED FOOTWAY

PROPOSED RAISED CROSSING

EXISTING FOOTWAY TO REMAIN

EXISTING CARRIAGEWAY TO REMAIN

PROPOSED SHARED SURFACE

EXISTING KERBLINE

INDICATIVE EXISTING TREE LOCATION



This drawing has been prepared for the use of AECOM's client. It may not be used, modified, reproduced or relied upon by third parties, except as agreed by AECOM or as required by law. AECOM accepts no responsibility, and denies any liability, whatsoever, to any party that uses or relies on this drawing without AECOM's express written consent. Do not scale this document. All measurements must be obtained from the stated dimensions.



PROJECT

PEDESTRIAN
ACCESSIBILITY
IMPROVEMENTS TO
GAELSCOIL DROICHEAD
NA BANNDAN

CLIENT



CONSULTANT

AECOM
DOUGLAS BUSINESS CENTRE
CARRIGALINE ROAD
DOUGLAS
CORK
Tel: +353 (0)21 436 5006
www.aecom.com

NOTES

- THIS DRAWING IS TO BE READ IN CONJUNCTION WITH ALL OTHER RELEVANT ENGINEERING DRAWINGS. ANY DISCREPANCIES, ERRORS OR OMISSIONS TO BE BROUGHT TO THE ATTENTION OF THE EMPLOYER.
- ALL DIMENSIONS TO BE CHECKED BY THE CONTRACTOR ON SITE PRIOR TO COMMENCEMENT OF WORKS.
- EMPLOYER'S REPRESENTATIVE TO BE INFORMED BY THE CONTRACTOR OF ANY DISCREPANCIES PRIOR TO THE COMMENCEMENT OF WORKS ON SITE.
- DIMENSIONS OF ALL BOUNDARIES AND ADJOINING ROADS TO BE CHECKED ON SITE PRIOR TO COMMENCEMENT OF WORKS.
- DO NOT SCALE. ALL MEASUREMENTS AND COORDINATES TO BE CHECKED ON SITE.

ISSUE/REVISION

C	JUNE 2022	ISSUED FOR SECTION 38
B	MAY 2022	ISSUED FOR SECTION 38
A	MARCH 2022	ISSUED FOR SECTION 38
I/R	DATE	DESCRIPTION

KEY PLAN

PROJECT NUMBER

60628497

SHEET TITLE

GENERAL ARRANGEMENT
GAELSCOIL DROICHEAD NA BANNDAN
SHEET 3 OF 4

SHEET NUMBER

60628497_SHT_30_SK_SZ_140.3

A GAELSCOIL DROICHEAD NA BANNDAN

140.3 Scale: 1:250 @ A1; 1:500 @ A3

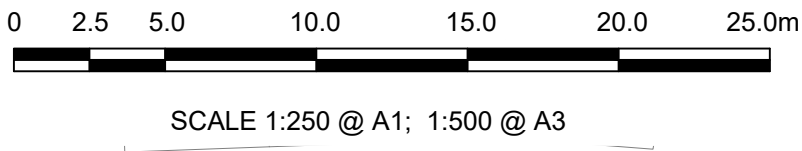

Filename: Z:\UK\IEOR\K1\085PR-450418_BANDON_TPREP\000_CAD_GIS\910_CAD\25-SKETCHES\SCHOOL_ZONES\GAELSCOIL DROICHEAD NA BANNDAN\20-SHEETS\80628497_SHT_30_SK_SZ_140.DWG
Last saved by: RYAN.OSULLIVAN Last Plotted: 2022-06-27

Project Management Initials: Designer: KOS Checked: MC Approved: EOM ISO A1 594mm x 841mm

ORDNANCE SURVEY IRELAND LICENCE NO CYAL50217544
©ORDNANCE SURVEY IRELAND / GOVERNMENT OF IRELAND

KEY:

PROPOSED CARRIAGEWAY RESURFACING

PROPOSED FOOTWAY

PROPOSED RAISED CROSSING

EXISTING FOOTWAY TO REMAIN

EXISTING CARRIAGEWAY TO REMAIN

PROPOSED SHARED SURFACE

EXISTING KERBLINE

INDICATIVE EXISTING TREE LOCATION

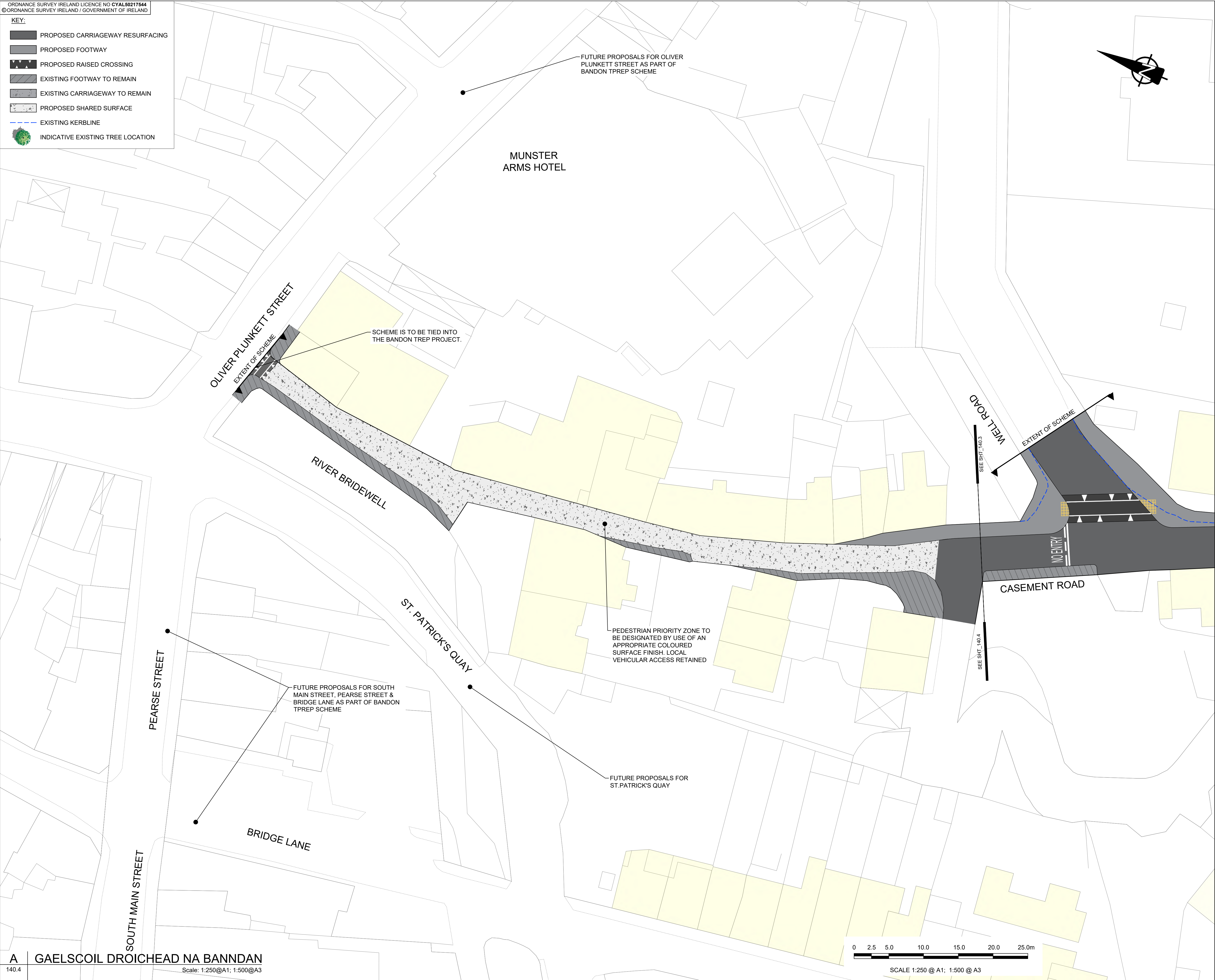

This drawing has been prepared for the use of AECOM's client. It may not be used, modified, reproduced or relied upon by third parties, except as agreed by AECOM or as required by law. AECOM accepts no responsibility, and denies any liability, whatsoever, to any party that uses or relies on this drawing without AECOM's express written consent. Do not scale this document. All measurements must be obtained from the stated dimensions.



PROJECT

PEDESTRIAN
ACCESSIBILITY
IMPROVEMENTS TO
GAELSCOIL DROICHEAD
NA BANNDAN

CLIENT



CONSULTANT

AECOM
DOUGLAS BUSINESS CENTRE
CARRIGALINE ROAD
DOUGLAS
CORK
Tel: +353 (0)21 436 5006
www.aecom.com

NOTES

1. THIS DRAWING IS TO BE READ IN CONJUNCTION WITH ALL OTHER RELEVANT ENGINEERING DRAWINGS. ANY DISCREPANCIES, ERRORS OR OMISSIONS TO BE BROUGHT TO THE ATTENTION OF THE EMPLOYER.
2. ALL DIMENSIONS TO BE CHECKED BY THE CONTRACTOR ON SITE PRIOR TO COMMENCEMENT OF WORKS.
3. EMPLOYER'S REPRESENTATIVE TO BE INFORMED BY THE CONTRACTOR OF ANY DISCREPANCIES PRIOR TO THE COMMENCEMENT OF WORKS ON SITE.
4. DIMENSIONS OF ALL BOUNDARIES AND ADJOINING ROADS TO BE CHECKED ON SITE PRIOR TO COMMENCEMENT OF WORKS.
5. DO NOT SCALE. ALL MEASUREMENTS AND COORDINATES TO BE CHECKED ON SITE.

ISSUE/REVISION

C	JUNE 2022	ISSUED FOR SECTION 38
B	MAY 2022	ISSUED FOR SECTION 38
A	MARCH 2022	ISSUED FOR SECTION 38
I/R	DATE	DESCRIPTION

KEY PLAN

PROJECT NUMBER

60628497

SHEET TITLE

GENERAL ARRANGEMENT
GAELSCOIL DROICHEAD NA BANNDAN
SHEET 4 OF 4

SHEET NUMBER

60628497_SHT_30_SK_SZ_140.4