

FOUL & SURFACE WATER NOTES:

- FOR SETTING OUT REFER TO ARCHITECT'S DRAWINGS.
- THIS DRAWING TO BE READ IN CONJUNCTION WITH ALL OTHER ARCHITECTURAL AND ENGINEERING DRAWINGS AND ALL OTHER RELEVANT DRAWINGS AND SPECIFICATIONS.
- FOR UNDER FLOOR DRAINAGE ARRANGEMENT PLEASE REFER TO ARCHITECT'S DRAWINGS.
- DO NOT SCALE THIS DRAWING. USE FIGURE DIMENSIONS ONLY.
- ALL SURFACE WATER SEWERS SHALL BE CARRIED OUT STRICTLY IN ACCORDANCE WITH THE RECOMMENDATIONS CONTAINED IN "RECOMMENDATIONS FOR SITE DEVELOPMENT WORKS FOR HOUSING AREAS" AS PUBLISHED BY DEPARTMENT OF ENVIRONMENT AND LOCAL GOVERNMENT AND IRISH WATER STANDARD DETAILS FOR WASTE WATER INFRASTRUCTURE.
- ALL FOUL SEWER WORKS TO BE CARRIED OUT IN ACCORDANCE WITH THE IRISH WATER CODE OF PRACTICE FOR WASTEWATER INFRASTRUCTURE & IRISH WATERS WASTE WATER INFRASTRUCTURE STANDARD DETAILS.
- GROUND LEVELS, COVER LEVELS AND INVERT LEVELS ARE APPROXIMATE ONLY. EXACT LEVELS TO BE CONFIRMED ON SITE.
- THE DEVELOPMENT SHALL BE CONNECTED TO THE PUBLIC SEWER TO THE SATISFACTION OF THE LOCAL AUTHORITY AND IRISH WATER. THE MINIMUM COVER TO ANY SEWER PIPE SHALL BE 1.2m IN ROAD AND 0.9m IN OPEN SPACES AND FOOTPATHS NOT ADJACENT TO CARRIAGEWAYS. WHERE IT IS NOT POSSIBLE TO ACHIEVE THESE MINIMUM COVERS, PIPES SHALL BE BEDDED AND SURROUNDED IN CONCRETE 150thk.
- THE SEWERS AND MANHOLES SHALL BE LAID AND TESTED TO THE SATISFACTION OF IRISH WATER AND THE LOCAL AUTHORITY. LAYING, BEDDING AND BACK FILLING OF SEWERS SHALL BE IN ACCORDANCE WITH THE IRISH WATER STANDARD DETAILS.
- ALL SERVICE TRENCHES IN ROADS SHALL BE BACK FILLED AND PROPERLY COMPACTED WITH GRANULAR MATERIAL IN ACCORDANCE WITH IRISH WATER STANDARD DETAILS FOR WASTEWATER INFRASTRUCTURE.
- GULLIES AT ALL GULLIES AND MANHOLES LOCATED IN THE ROAD/ CAR PARK AREA SHALL BE LOCKING TYPE. GULLIES TO BE LOCATED EVERY 45m OR 200m² OF HARD STANDING. B) DOUBLE GULLIES TO BE PROVIDED AT ALL ROAD SAG CURVES AND CUL DE SACS WHERE INDICATED. SEPARATE CONNECTIONS SHALL BE PROVIDED FOR EACH GULLY.
- SECONDARY DRAINAGE INCLUDING BIGTS, AJs, RWP's, DOOR THRESHOLD DRAINS ETC, OMITTED AT THIS STAGE.

LEGEND:

- SWMH_01
XXX @ 1/XX DENOTES STORM WATER MANHOLE REF AND INVERT LEVEL WITH STORM WATER SEWER DIAMETER AND GRADIENT. ALL STORM WATER SEWERS TO BE HDPE WITH MIN. STIFFNESS CLASS SN8.
- SWIC_01
XXX @ 1/XX DENOTES STORM WATER INSPECTION CHAMBER REF AND INVERT LEVEL WITH STORM WATER DIAMETER AND GRADIENT. ALL STORM WATER SEWERS TO BE HDPE WITH MIN. STIFFNESS CLASS SN8.
- AJ DENOTES STORM WATER 300mm Dia. AJ
- FWMH_01
XXX @ 1/XX DENOTES FOUL MANHOLE REF AND INVERT LEVEL WITH FOUL WATER SEWER DIAMETER AND GRADIENT. ALL FOUL WATER SEWERS TO BE HDPE WITH MIN. STIFFNESS CLASS SN8.
- FWIC_01
XXX @ 1/XX DENOTES FOUL WATER INSPECTION CHAMBER REF AND INVERT LEVEL WITH FOUL WATER SEWER DIAMETER AND GRADIENT. ALL FOUL WATER SEWERS TO BE HDPE WITH MIN. STIFFNESS CLASS SN8.
- AJ DENOTES FOUL WATER 300mm Dia. AJ
- ACO DRAIN TO ARCHITECT'S SPECIFICATION
- BIGT BACK INLET GULLY TRAP
- AJ ACCESS JUNCTION
- RWP RAIN WATER PIPE (REF ARCHITECT'S DR'S FOR LOCATIONS)
- RG ROAD GULLY WITH D400 RATING TO COVER

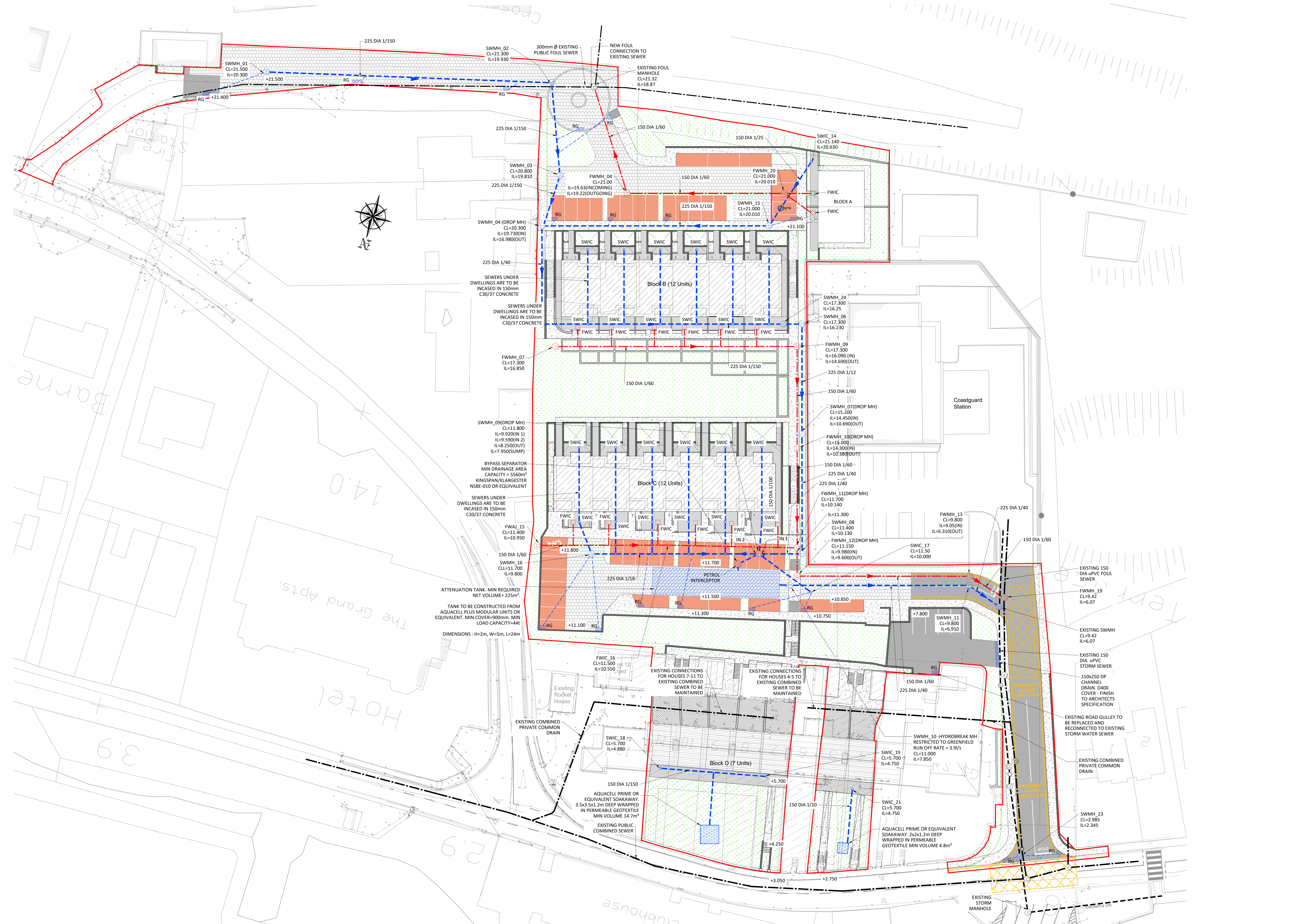

PROPOSED DRAINAGE LAYOUT
SCALE 1:250

- FOR SETTING OUT REFER TO ARCHITECT'S DRAWINGS.
- THIS DRAWING TO BE READ IN CONJUNCTION WITH ALL OTHER ARCHITECTURAL AND ENGINEERING DRAWINGS AND ALL OTHER RELEVANT DRAWINGS AND SPECIFICATIONS.
- DO NOT SCALE THIS DRAWING. USE FIGURE DIMENSIONS ONLY.
- NO PART OF THIS DOCUMENT MAY BE REPRODUCED OR TRANSMITTED IN ANY FORM OR STORED IN ANY RETRIEVAL SYSTEM OF ANY NATURE WITHOUT THE WRITTEN PERMISSION OF O'CONNOR SUTTON CROMIN AS COPYRIGHT HOLDER EXCEPT AS AGREED FOR USE ON THE PROJECT FOR WHICH THE DOCUMENT WAS ORIGINALLY ISSUED.

Rev No.	Date	Revision Note	Drn by	Chkd by	Rev No.	Date	Revision Note	Drn by	Chkd by
C01	20/10/22	ISSUED FOR PLANNING	CW	CM					

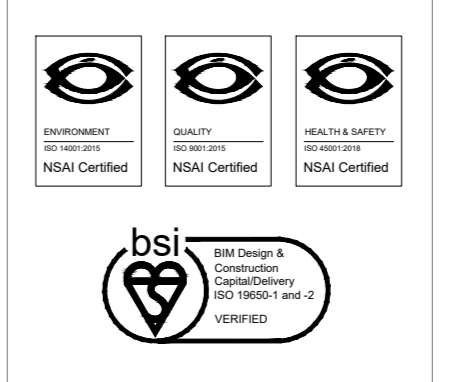

North Point House,
North Point Business Park,
New Mallow Road,
Cork.
TEL +353 (0)21 2355816
www.ocsc.ie
Dublin London Belfast Galway Cork Birmingham

Client: CORK COUNTY COUNCIL
Project: RESIDENTIAL DEVELOPMENT CROSSHAVEN, LOWER ROAD
Title: DRAINAGE LAYOUT PLAN
Code Originator: Zone | Level | Type | Role | Number | Status | Revision
C1003 OCSC · XX · XX · DR · C · 0011 · A1 · C01
Date: 23/09/22 Scale: A/S @ AD Drn by: CW Chkd by: CM Aprvd by: JMcB