

FIRE TENDER SWEPT PATH ANALYSIS 1

SCALE 1:200

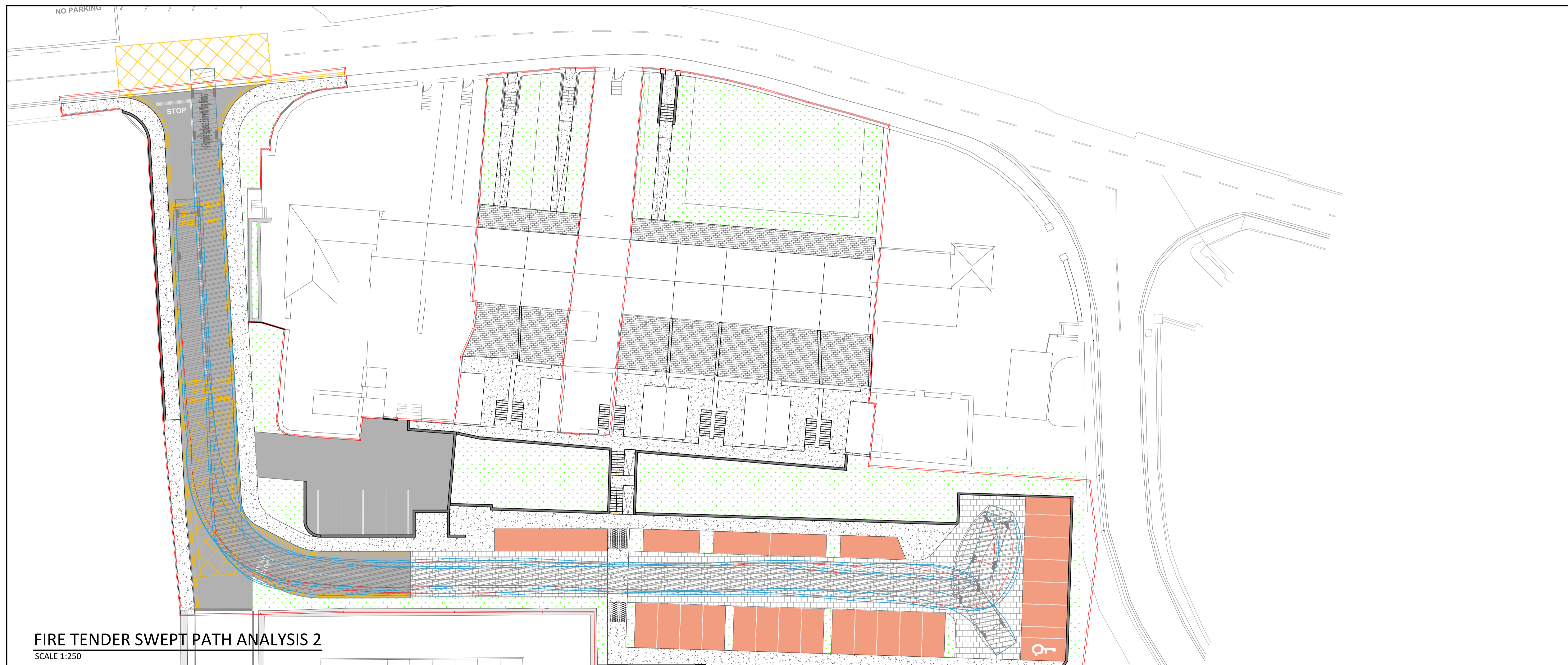

FIRE TENDER SWEPT PATH ANALYSIS 2

SCALE 1:250

LEGEND:

FORWARD MOVEMENT REVERSING MOVEMENT

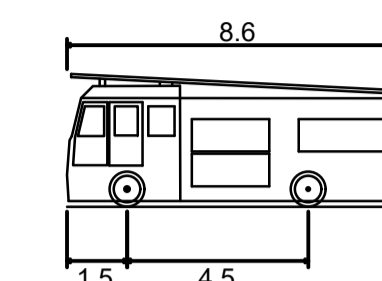
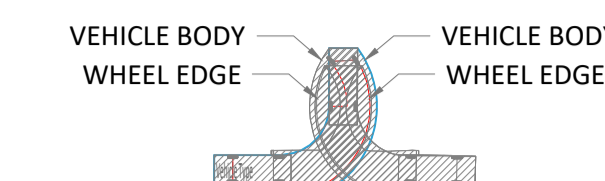

Pumping Appliance (8.60m)
 Overall Length 8.600m
 Overall Width 2.500m
 Overall Body Height 3.300m
 Min Body Ground Clearance 0.140m
 Track Width 2.500m
 Lock-to-lock time 4.00s
 Curb to Curb Turning Radius 7.750m

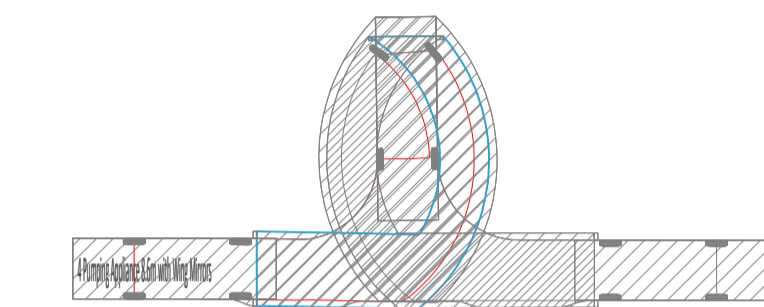

- FOR SETTING OUT REFER TO ARCHITECT'S DRAWINGS.
- THIS DRAWING TO BE READ IN CONJUNCTION WITH ALL OTHER ARCHITECTURAL AND ENGINEERING DRAWINGS AND ALL OTHER RELEVANT DRAWINGS AND SPECIFICATIONS.
- DO NOT SCALE THIS DRAWING. USE FIGURED DIMENSIONS ONLY.
- NO PART OF THIS DOCUMENT MAY BE REPRODUCED OR TRANSMITTED IN ANY FORM OR STORED IN ANY RETRIEVAL SYSTEM OF ANY NATURE WITHOUT THE WRITTEN PERMISSION OF O'CONNOR SUTTON CROMIN AS COPYRIGHT HOLDER EXCEPT AS AGREED FOR USE ON THE PROJECT FOR WHICH THE DOCUMENT WAS ORIGINALLY ISSUED.

Rev No.	Date	Revision Note	Drn by	Chkd by
C01	20/10/22	ISSUED FOR PLANNING	CW	CM

Rev No.	Date	Revision Note	Drn by	Chkd by

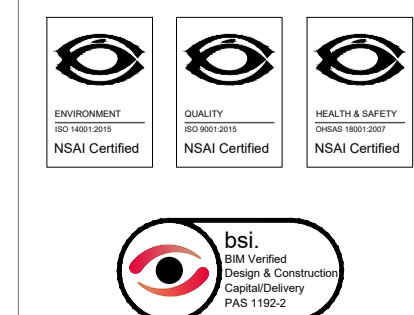

North Point House,
 North Point Business Park,
 New Mallow Road,
 Cork.
 TEL +353 (0)21 2355816
 e: contactus@ocsc.ie
 w: www.ocsc.ie
 Dublin | London | Belfast | Galway | Cork | Birmingham



Client: CORK COUNTY COUNCIL
 Project: CROSSHAVEN DEVELOPMENT
 Title: SWEPT PATH ANALYSIS
 FIRE TENDER
 Code Originator Zone Level Type Role Number Status Revision
 C1003 OCSC XX XX DR C 0062 A1 C01
 Date: 11/21 Scale: 1/250 @ A1 Drn by: CW Chkd by: CM Aprvd by: JMcB