

**WATERMAIN NOTES:**

- FOR SETTING OUT REFER TO ARCHITECTS DRAWINGS.
- THIS DRAWING IS TO BE READ IN CONJUNCTION WITH ALL OTHER ARCHITECTURAL AND ENGINEERING DRAWINGS AND ALL OTHER RELEVANT DRAWINGS AND SPECIFICATIONS.
- DO NOT SCALE THIS DRAWING. USE FIGURE DIMENSIONS ONLY.
- ALL WORKS SHALL BE CARRIED OUT STRICTLY IN ACCORDANCE WITH THE RECOMMENDATIONS CONTAINED IN "RECOMMENDATIONS FOR SITE DEVELOPMENT WORKS FOR HOUSING AREAS" AS PUBLISHED BY DEPARTMENT OF ENVIRONMENT AND LOCAL GOVERNMENT AND IRISH WATER STANDARD DETAILS FOR WATER INFRASTRUCTURE.
- WATERMAIN SHALL BE MINIMUM 80mm HDPE, LAID OUT AS INDICATED ON SITE PLAN. IN ADDITION ON SITE PLAN SLUICE VALVES SHALL BE FITTED ON EACH CHL-BE-SAC. SLUICE VALVE TYPE SHALL BE AGREED WITH IRISH WATER BEFORE INSTALLATION.
- EACH DEAD-END MAIN SHALL TERMINATE WITH A HYDRANT FOR FLUSHING PURPOSES.
- STOP COCKS SHALL BE PROVIDED ON EACH SERVICE PIPE AND SHALL COMPLY WITH BS 1010. AN APPROPRIATE WATER SERVICE CONTROL UNTIL TO BE INSTALLED AT POINT OF INDIVIDUAL CONNECTION TO BE THE WATERMAIN.
- MINIMUM COVER TO ALL WATERMAINS SHALL BE IN ACCORDANCE WITH IRISH WATER STANDARD DETAILS, REFER TO DRAWING 0024 FOR DETAILS.
- WATERMAIN SHALL BE LAID AND TESTED IN ACCORDANCE WITH THE IRISH WATER CODE OF PRACTICE FOR WATER INFRASTRUCTURE.
- MARKER STRIPS SHALL BE LAID IN THE TRENCHES IDENTIFYING THE SERVICES UNDERNEATH.
- INDICATOR PLATES SHALL BE ERECTED ADJACENT TO ALL FIRE HYDRANTS AND SLUICE VALVES.

**LEGEND:**

- S.V. SLUICE VALVE
- B.B. STOP COCK
- F.M. FLOW METER
- H.Y.D. FIRE HYDRANT
- W.O. WASHOUT HYDRANT
- T.B. THRUST BLOCK
- 100mm DIAMETER HDPE WATERMAIN
- EXISTING WATERMAIN

**THRUST BLOCKS:**

- ANCHOR BLOCKS SHALL BE GRADE C25/30 CONCRETE AND SHALL BE PLACED AROUND PRESSURE PIPES AT BOTH SIDES OF ALL VALVE CHAMBERS AND AT BENDS OF GREATER CURVATURE THAN 22.5°
- BLOCKS SHALL BE TAKEN 150MM BELOW THE PIPE INVERT FOR THE FULL WIDTH OF TRENCH AND SHALL ENCASE THE PIPES TO 150MM OVER THE TOP OF THE BARREL.
- THE MIN. LENGTH OF ANCHOR BLOCK SHALL BE 600MM FOR PIPES UP TO 1500. FOR PIPES GREATER THAN 1500 THE MINIMUM LENGTH SHALL BE TAKEN AS 900mm.
- ANCHOR BLOCKS SHALL BE PROVIDED AT ALL DEAD ENDS, TEES & TAPERS.
- STEELY INCLINED PIPELINES SHALL BE SECURED BY TRANSVERSE ANCHOR BLOCKS SPACED IN ACCORDANCE WITH THE FOLLOWING TABLE.

GRADIENT	SPACING
1 IN 2 AND STEEPER	05.5m
1 IN 2 - 1 IN 4	11.0m
1 IN 4 - 1 IN 5	16.6m
1 IN 5 - 1 IN 6	22.0m

- ANCHOR BLOCKS ON STEELY INCLINED PIPELINES SHALL PROJECT EQUALLY INTO EACH SIDE. OTHER DIMENSIONS SHALL BE AS DETAILED ABOVE.

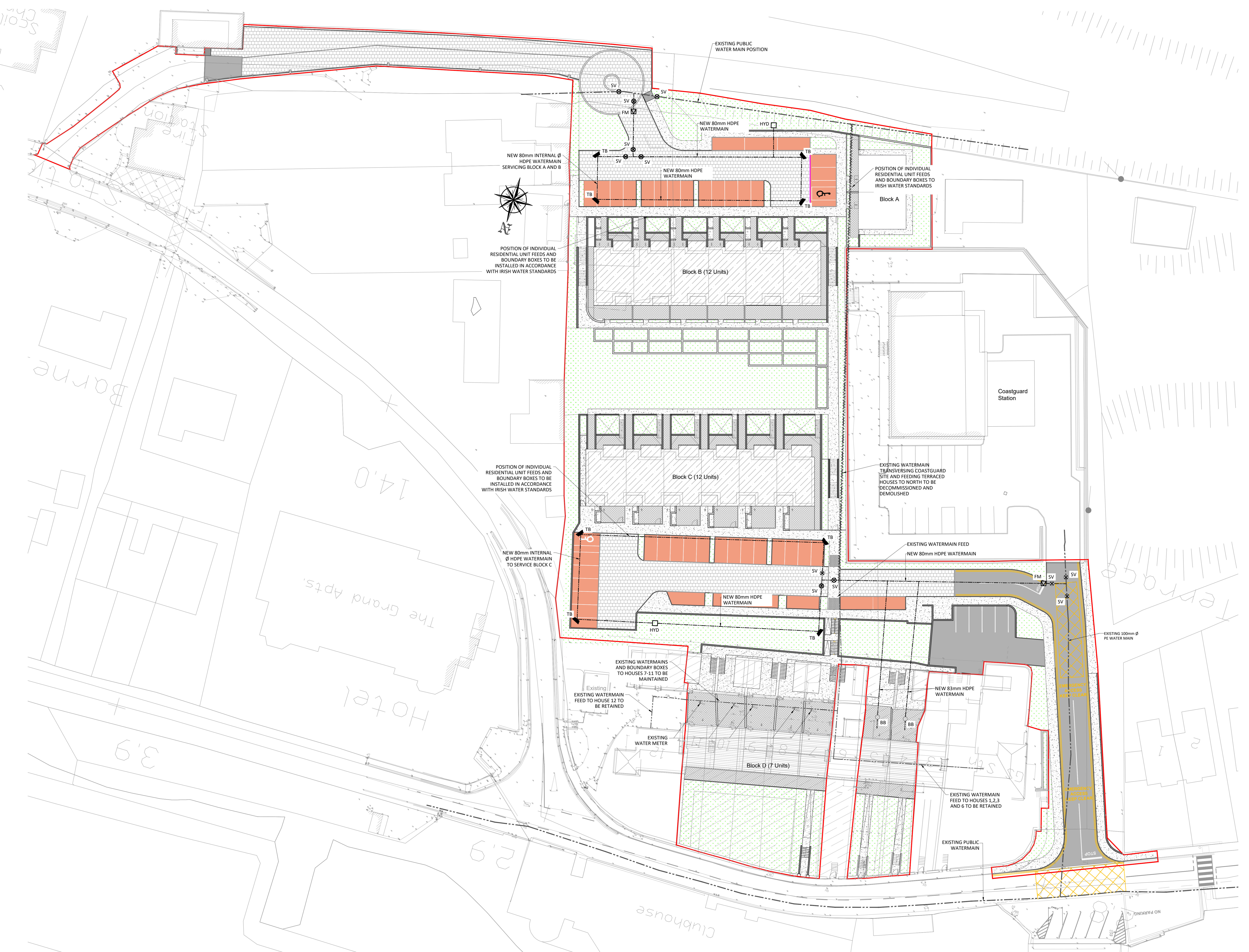

**PROPOSED WATERMAIN LAYOUT**  
SCALE 1:250

- FOR SETTING OUT REFER TO ARCHITECTS DRAWINGS.
- THIS DRAWING IS TO BE READ IN CONJUNCTION WITH ALL OTHER ARCHITECTURAL AND ENGINEERING DRAWINGS AND ALL OTHER RELEVANT DRAWINGS AND SPECIFICATIONS.
- DO NOT SCALE THIS DRAWING. USE FIGURED DIMENSIONS ONLY.
- NO PART OF THIS DOCUMENT MAY BE REPRODUCED OR TRANSMITTED IN ANY FORM OR STORED IN ANY RETRIEVAL SYSTEM OF ANY NATURE WITHOUT THE WRITTEN PERMISSION OF O'CONNOR SUTTON CROMIN AS COPYRIGHT HOLDER EXCEPT AS AGREED FOR USE ON THE PROJECT FOR WHICH THE DOCUMENT WAS ORIGINALLY ISSUED.

Rev No.	Date	Revision Note
C01	20/10/22	ISSUED FOR PLANNING

Drn by / Chkd by  
CW / CM

Rev No.	Date	Revision Note

Drn by / Chkd by

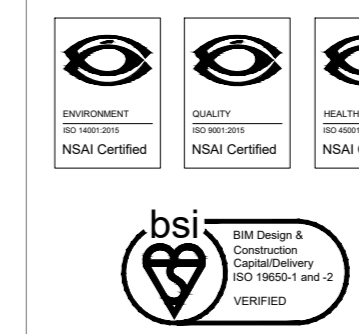

North Point House,  
North Point Business Park,  
New Mallow Road,  
Cork.  
TEL +353 (0)21 2355816  
e: contactus@ocsc.ie  
w: www.ocsc.ie  
Dublin London Belfast Galway Cork Birmingham



Client: CORK COUNTY COUNCIL  
Project: RESIDENTIAL DEVELOPMENT CROSSHAVEN, LOWER ROAD  
Title: WATERMAIN LAYOUT PLAN  
Code Originator: Zone | Level | Type | Role | Number | Status | Revision  
C1003 OCSC · XX · XX · DR · C · 0021 A1 C01  
Date: 23/09/22 Scale: A/S @ A0 Drn by: CW Chkd by: CM Aprvd by: JMcB