

**CUNNANE STRATTON REYNOLDS**  
**LAND PLANNING & DESIGN**

**Green Park Youghal Co. Cork**  
**Landscape Design Rationale**

PROJECT NO. 21501

JUNE 2021





## Introduction & Context

The Minister for Tourism, Culture, Arts, Gaeltacht, Sport and Media, Catherine Martin T.D., announced a new funding scheme The *Outdoor Public Space Scheme 2021* to help local authorities open up and create public spaces and facilities dedicated to the arts, culture and festivals.

The brief is for an outdoor space in Youghal which is flexible, innovative and useable year-round. It should respond to the challenges associated with COVID-19 and support the recovery of the creative, cultural, entertainment and events sector as well as being future-proofed from a health and safety perspective. It should have added benefits for tourism, the hospitality sector, and be supportive of the night-time economy of Youghal.

Green Park, a formal Victorian style park with manicured lawn and a central linear arrangement of protected monuments, is situated between the busy town centre of Youghal, and the popular long stretch of beach amenity to the south.

The intention is to promote this park as a contemporary flexible events space through sensitive intervention which protects and enhances the existing character of the park and retains Green Park's status as a unique green open space along the waterfront of the town of Youghal.



Historical Context Imagery

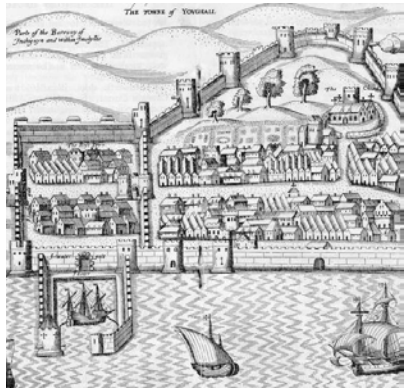

Youghal as a walled town and harbour



Youghal's Exchange and Quay  
 N. The Exchange. R. The head of one Drumada (whose father hangs in chains near Youghal), and who with five more were executed at Cork for Piracy and murder committed upon a Dutch vessel. A principal actor in this Villany, who advised to leave not one alive therein) was one Fica.  
 Dinely Drawing of Exchange & Quay in Youghal (c. 1661-1681)



The Prospect of Youghal from Cork road.  
 a. The Church St. Marys. b. Ruines of Ensilbegg Church. d. The Key. T. The Exchange. M. Monastra Hill in the County of Waterford. R. Colledge Garden. L. The Ferry Point. D. Part of the Dessea.  
 Dinely Drawing of Ferrypoint & Youghal (circa 1661-1681)



Youghal as a popular seaside resort



The Great Park, Youghal, Co. Cork.

QUEENS PARK, YOUGHAL



BAND STAND, GREEN PARK, YOUGHAL.



Part of Town and Green Park, Youghal. 710.

Current Park Use & Character



1. Service structures contained in northwest area



9. Building edge to park



2. Furniture competing with monuments



3. Access to promenade raised above beach and park



4. Access to beach



5. Picnic benches sheltered in walled park with no sea view



7. Picnic area with art wall, Transition from stone wall to railing on promenade



8. Steps to promenade



6. Large green space for kick-about and for events like Ironman (below)



Existing Circulation & Permeability

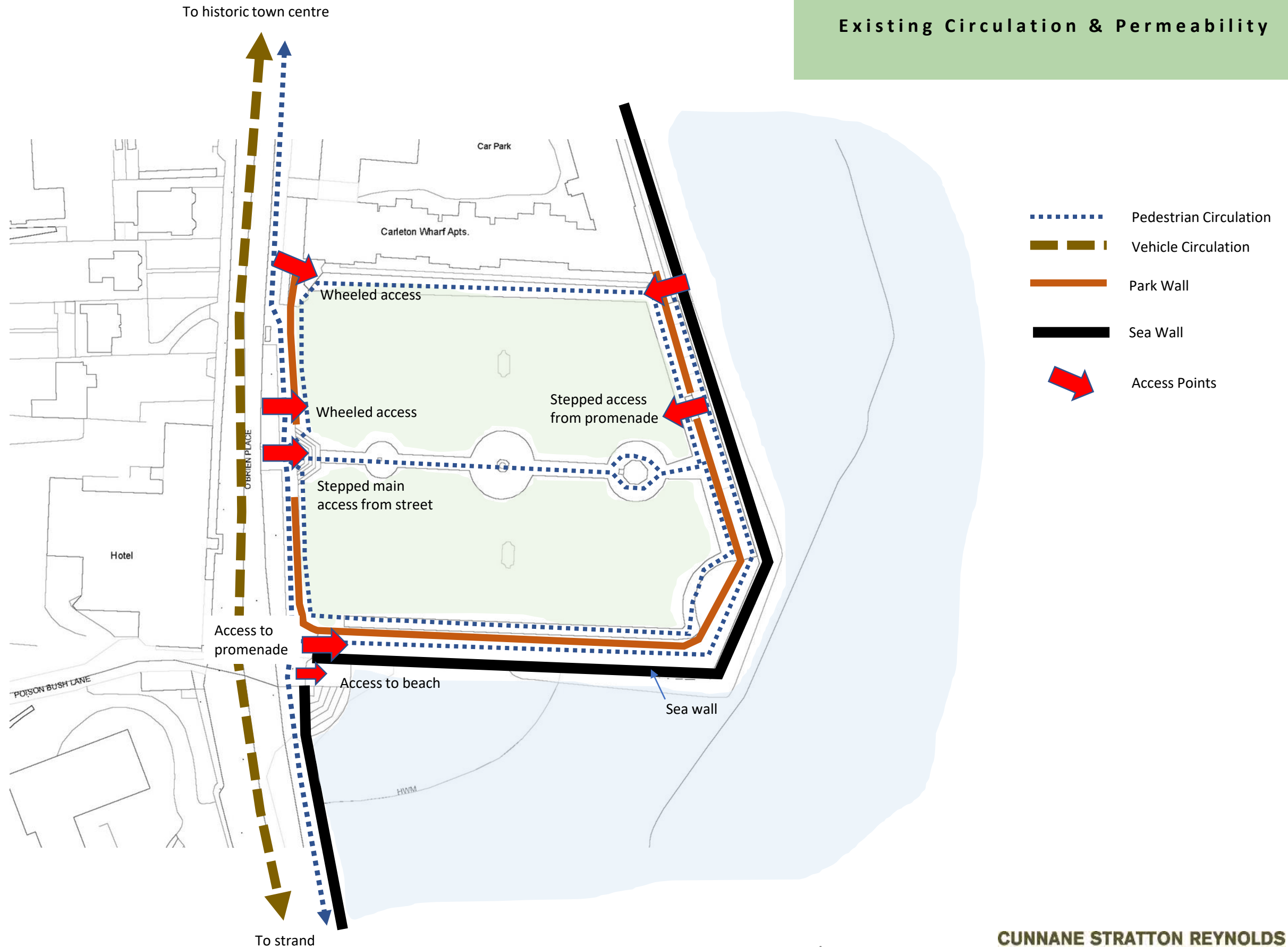

Landscape Character & Visual Impact Considerations

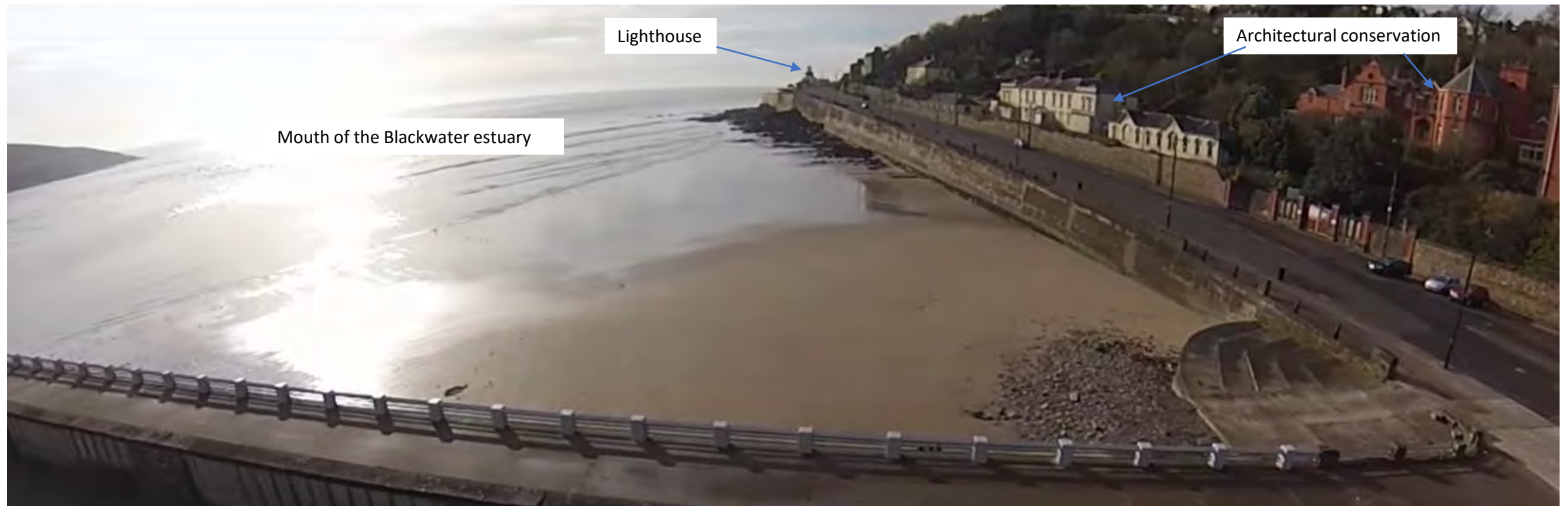

Constraints & Opportunities

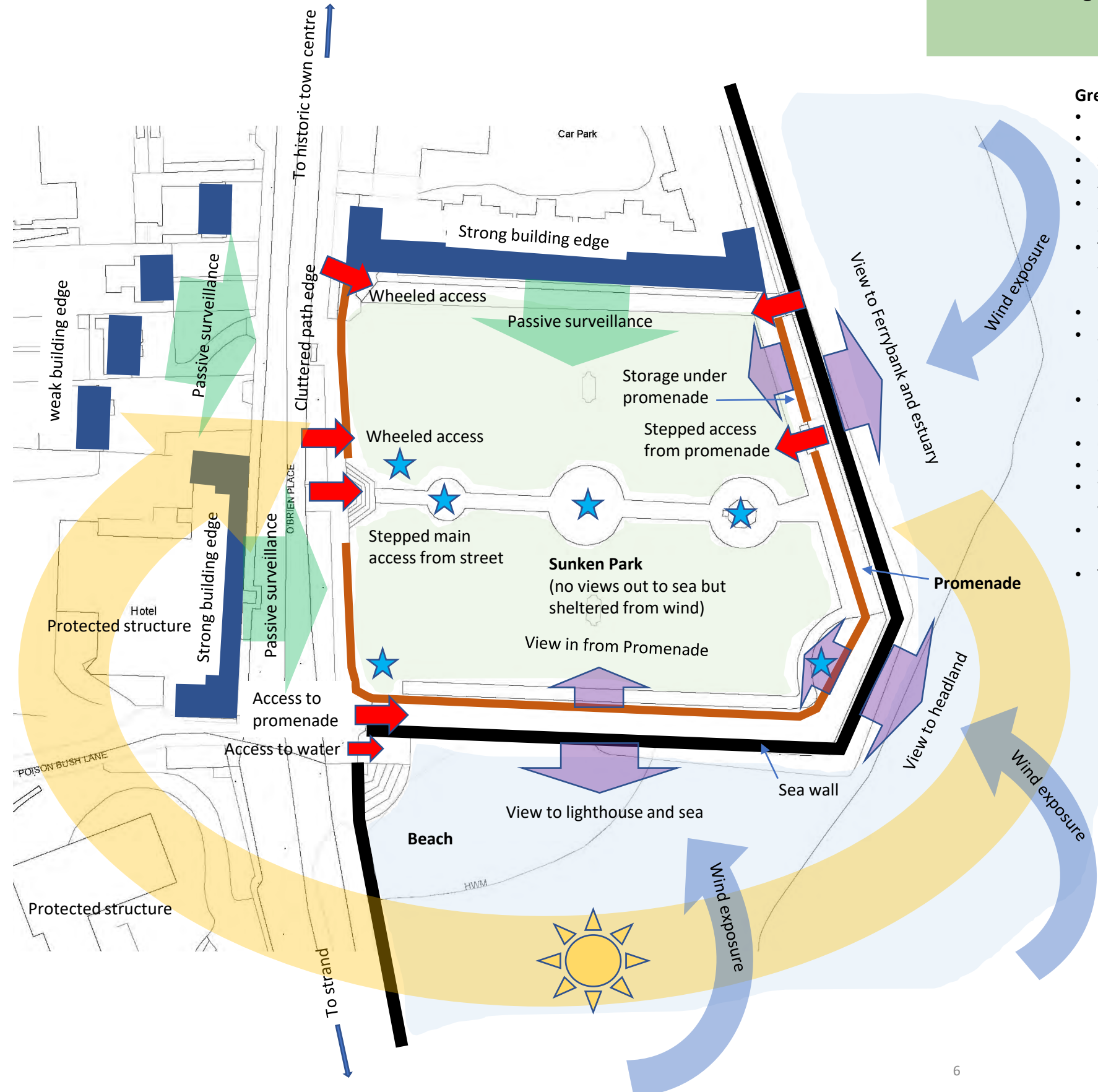

- Green Park Highlights & Observations**
- Prominent site projecting out into the estuary.
  - Halfway between strand and historic town core.
  - Singular usable green public space along water's edge.
  - All day sun.
  - Sunken walled park sheltered from the brunt of the sea/estuary winds.
  - Three typologies of space; the promenade along the sea wall, the sunken garden and the beach, all separated by level changes.
  - Boundary to the sea/estuary to the east and south.
  - Strong building edge to the north and west with some lack of definition / building frontage in the northwest corner.
  - Strong axis created by central path and alignment of monuments.
  - Geometric octagonal and circular forms.
  - Some disconnect between the upper and lower levels.
  - With the parks proximity to the waters edge there is no view to the water from within the sunken park.
  - Locally important space for kick-about, events etc with plenty of seating for elderly/all ages.
  - The 18th Century Walter Raleigh Hotel faces onto the Park.

★ Park Monuments, Memorials & Sculpture/Art  
 Park Wall  
 Sea Wall  
➔ Access Points  
↻ Exposed to sea/estuary  
↻ Wind exposure



## Green Park Enhancement Concept

The intention is to retain and enhance the green infrastructure of Green Park as the only green usable open space along the sea edge in the Town of Youghal between the town centre to the north and main beach area to the south

The development scheme aims to provide

- Flexible outdoor space
- Diversity in scale
- Innovative design
- Facilitate year-round use
- Future-proofed from a health and safety perspective
- Support the recovery of the creative, cultural, entertainment and events sector
- Benefits for the tourism and the hospitality sector.
- Space for arts & cultural activities
- A strong culture and tourism offering.

Items to be included

- Permanent / fixed weather proof coverings
- Paving / durable flooring
- Stage / physical structures
- Permanent seating e.g. Benches & Tables
- Outdoor projector screens
- Pavilion
- Outdoor lighting
- CCTV
- Removable bollards



(See Cork County Council Architects Department  
*Bandstand* Design Exploration Document)

Inspiring Images



Park Intervention Options no. 1,2&3

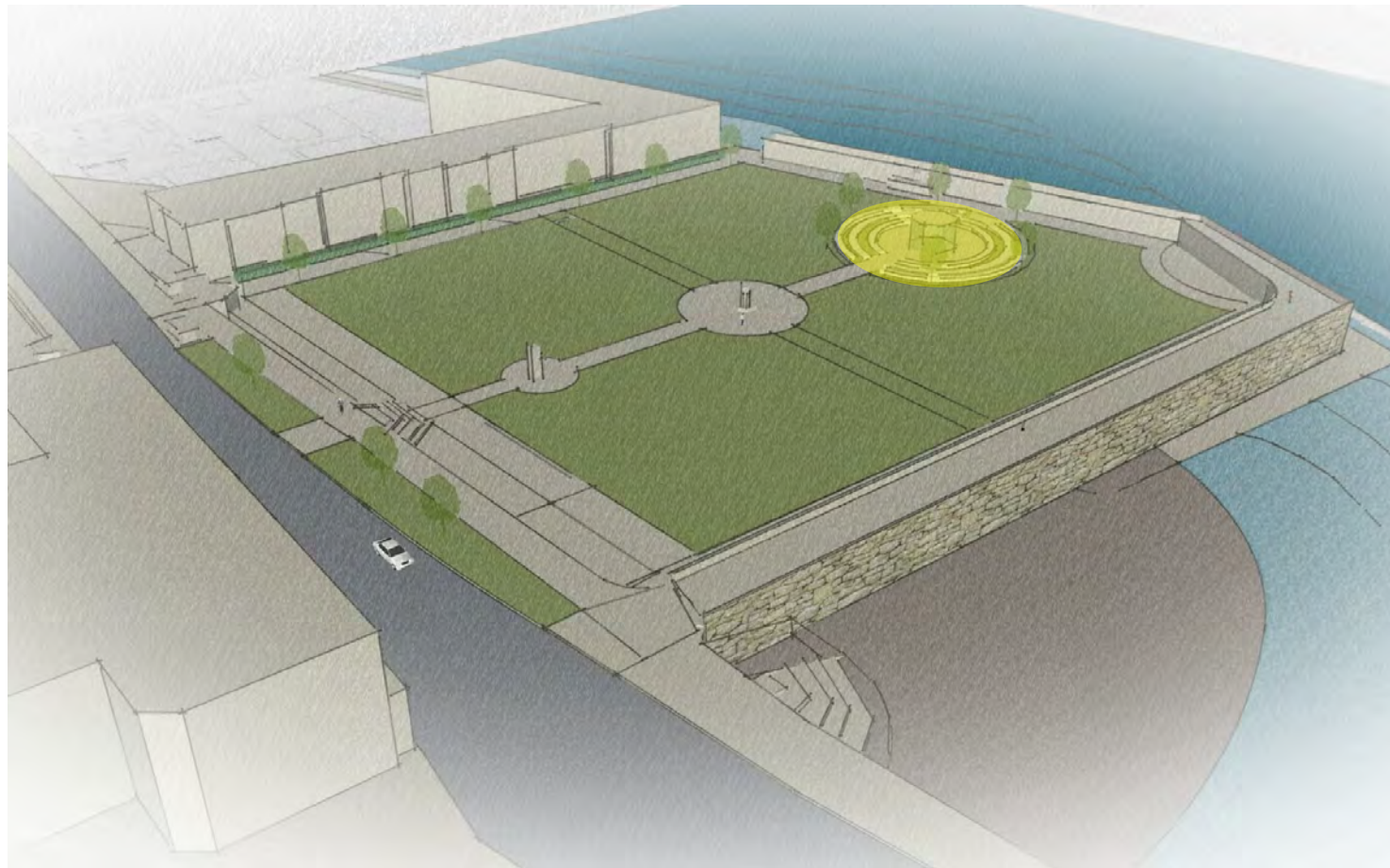

**Option 1**

The existing band stand.

Pros & Cons:

- Enhances the visual prominence of the band stand shelter with circular seating and backdrop of trees
- This requires minimal intervention to the existing Park layout and maximised the existing band stand.
- May be only suitable for small events

**Option 2**

Integrate a stage element into the northwest corner.

Pros & Cons:

- Close to services
- Screened from the street with the existing clutter of service structures.
- Can be viewed from the promenade
- This location may cause a nuisance to residents in the apartment building.

**Option 3**

Integrate a stage element into the southeast corner against the wall.

Pros & Cons:

- May visually compete with the band stand
- Reduced function of the promenade as a viewing platform
- Will cover the Art Wall
- Sheltered from the sea

*Note: For all options the intention is to retain and enhance the green infrastructure of Green Park as the only green usable open space along the sea edge in the Town of Youghal*

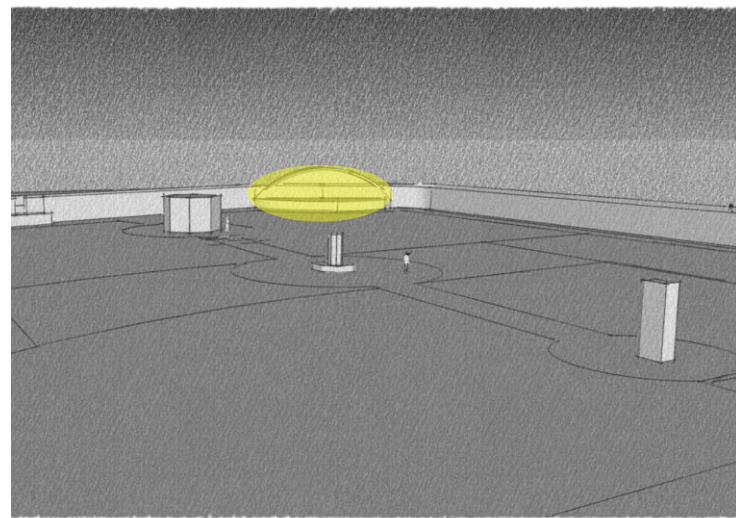
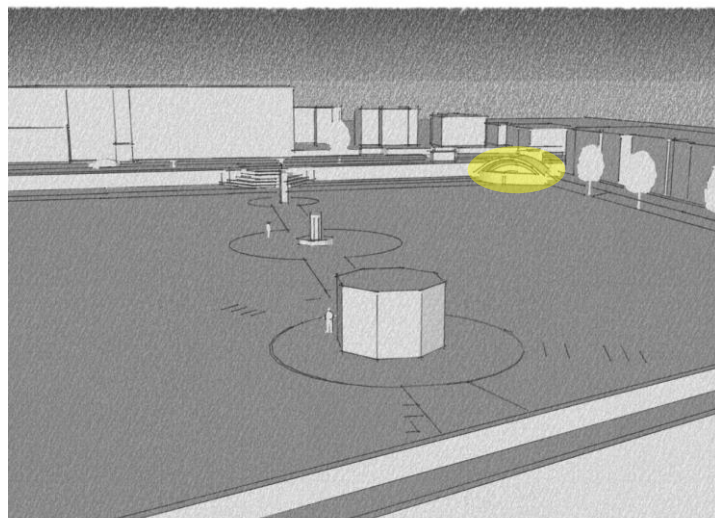

Park Intervention Option no. 4

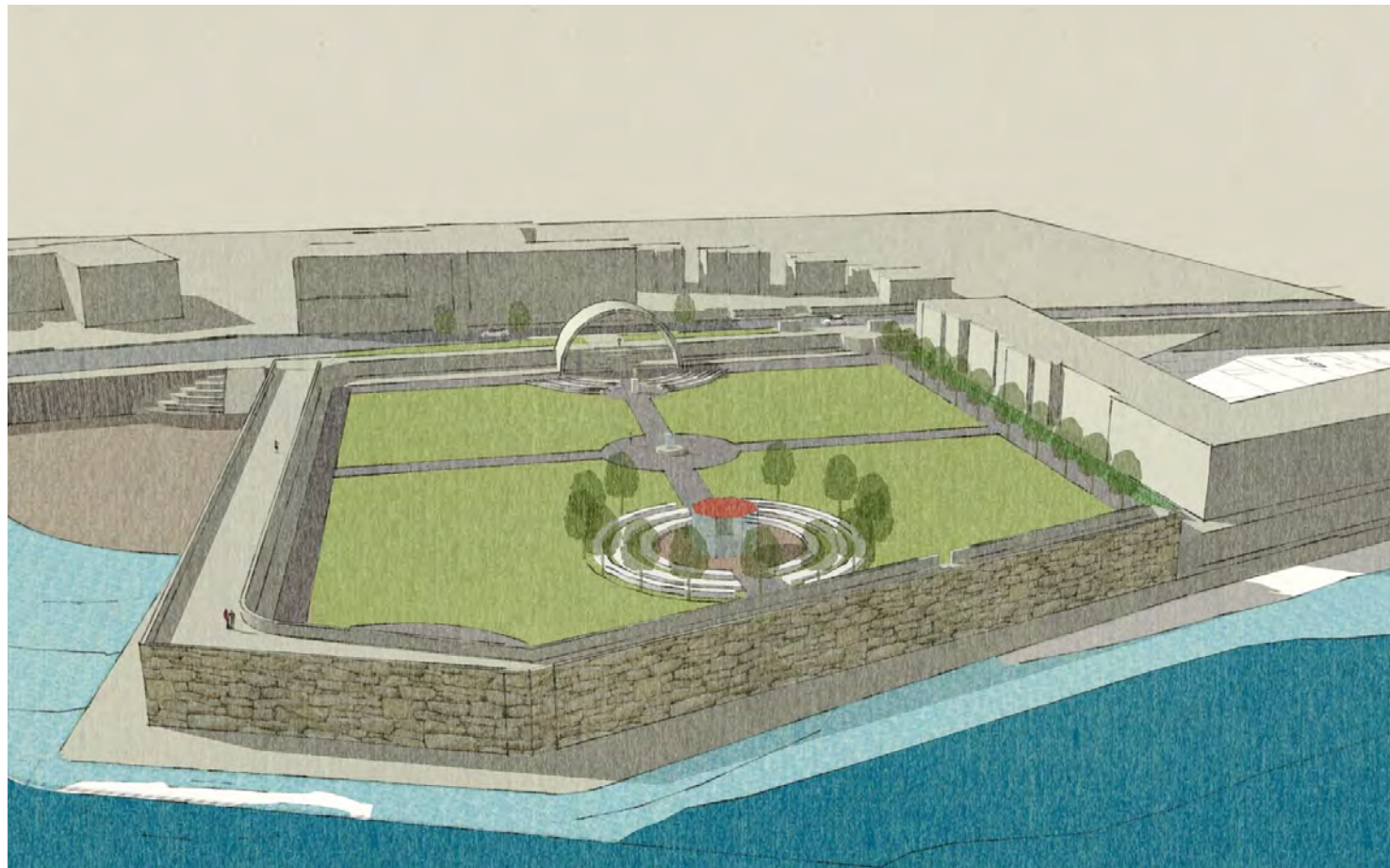

Option 4

Gateway to Park

Pros & Cons:

- Strategic placement of a stage element aligned with the existing axis of the park
- Function also as an interactive gateway to the Park and sculptural element along the streetscape together with narrowing the road for traffic calming
- Strengthen geometric forms vertically and horizontally in line with the historic arrangement of the Park
- The events shelter (dependent on design) may frame a view of the protected monuments in the Park.
- Improve circulation routes by reinstating the central transecting path to form quadrants and an implied geometric square.
- Raised promenade with sea views not interfered with.
- Retain and enhance the green infrastructure of Green Park as the only green usable open space along the sea edge in the Town of Youghal.
- Retain the grass areas for marquees for larger events e.g. Ironman etc.
- Option 1 may be incorporated with enhanced seating to the existing band stand.
- May require additional access points if stage being used for an event i.e. steps/ramp in south-western corner of park.

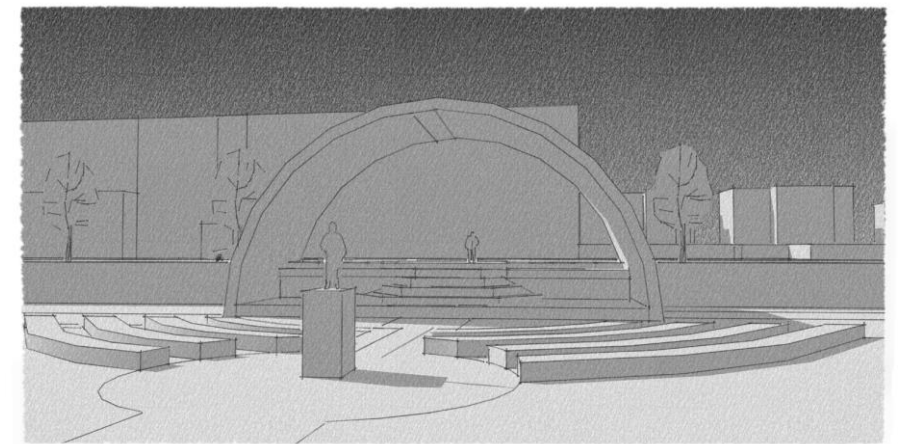
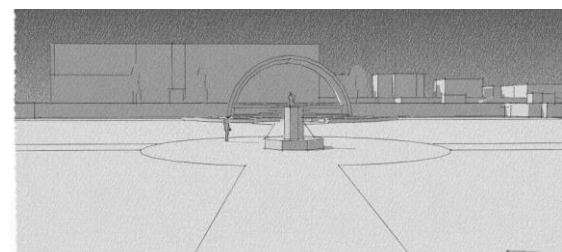
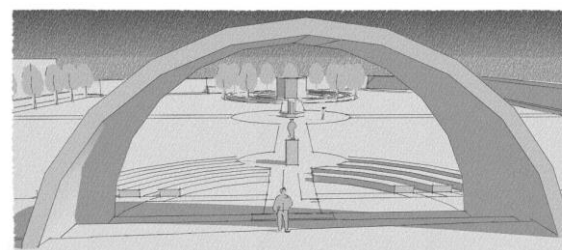
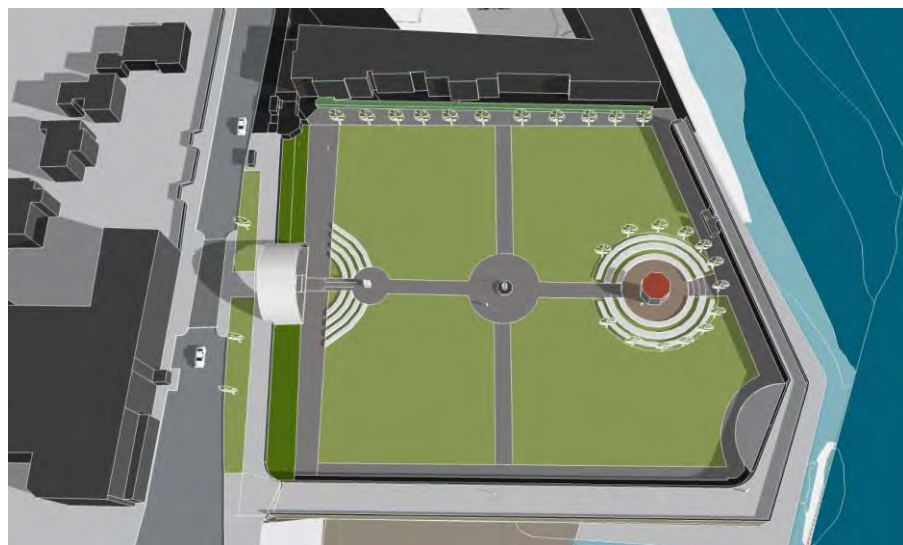

**Preferred Park Intervention Option:  
Option no. 4**

**Option 4**

**Gateway to Park**

Option 4 is the preferred option for intervention in the park based on the following qualities:

- The proposed location of public events space aligns with the existing east to west axis of the park along which key features are positioned including bandstand, sculpture and memorial and will, therefore, integrate well in the park.
- The existing band stand to be retained and defined with tree planting as a smaller event space
- The existing layout of the park will be largely preserved and the potential for re-instatement of an historical north-south path is highlighted which would divide the lawn space into quadrants and enhance circulation options within the park.
- The large green lawn spaces of the park will not be significantly impacted
- The new space will provide an identifiable node at the southern gateway to Youghal which will enhance the streetscape and encourage access into the park.
- The space will be flexible and multi-functional aimed at accommodating organised events and informal social engagement, with east-facing orientation for evening projected screen events.
- Streetscape enhancement and traffic calming measures can be delivered hand in hand with the new space in line with the principles set out in the Design Manual for Urban Roads and Streets (DMURS) incorporating features such as tree planting, raised crossing tables, mood lighting and high-quality hard and soft landscape treatments.
- The inclusion of a bespoke performance pavilion will play a part in the place-making potential of the project.

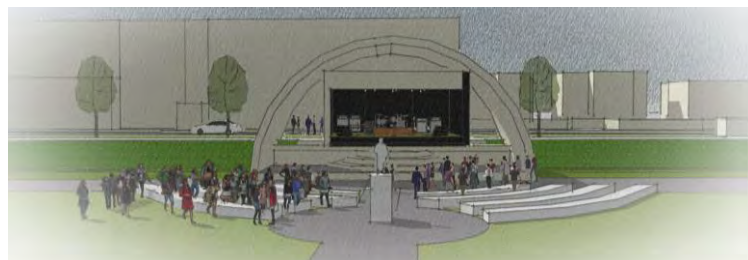

Preferred Park Intervention Option:  
Option no. 4 Landscape Masterplan

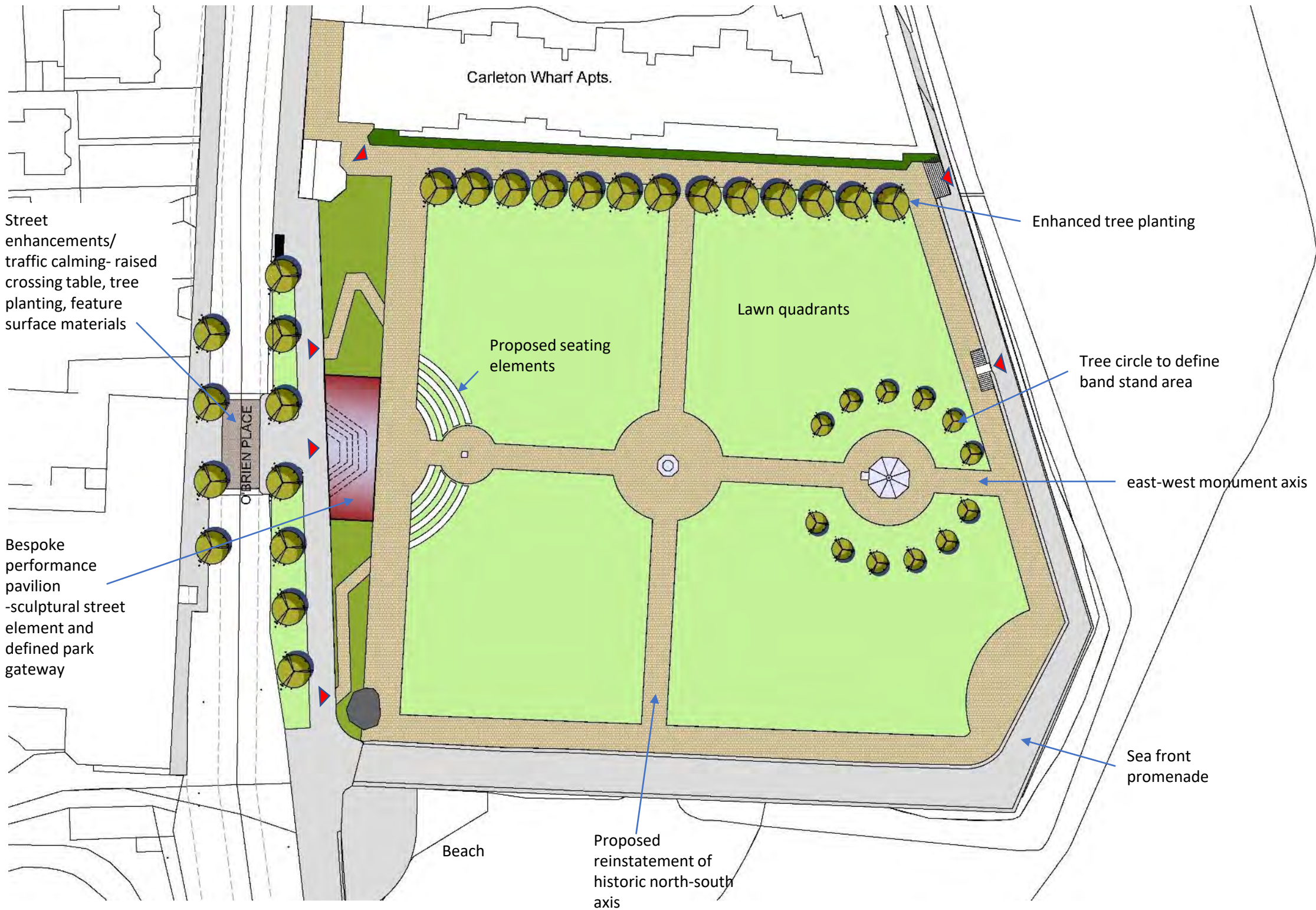

Street enhancements/  
traffic calming- raised  
crossing table, tree  
planting, feature  
surface materials

Bespoke  
performance  
pavilion  
-sculptural street  
element and  
defined park  
gateway

Carleton Wharf Apts.

Lawn quadrants

Proposed seating  
elements

Enhanced tree planting

Tree circle to define  
band stand area

east-west monument axis

Sea front  
promenade

Beach

Proposed  
reinstatement of  
historic north-south  
axis

O'BRIEN PLACE